



General Power Transformer < SMD Type:CM Series >

Type: CM-5NN

◆ Product Description

- 5.5×5.7mm Max.(L×W), 4.7mm Max. Height.
- In addition to the typical versions of parameters shown here, custom designs are available to meet your exact requirements.

◆ Feature

- Magnetically unshielded construction.
- Ideally used in power supply for DSC、DVC、Note PC, can be also used as power choke.
- RoHS Compliance

◆ Dimensions (mm)

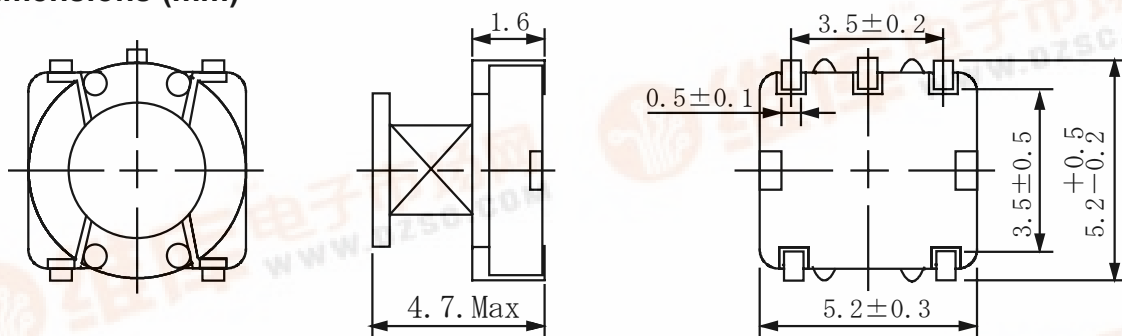

◆ Schematics (Bottom)

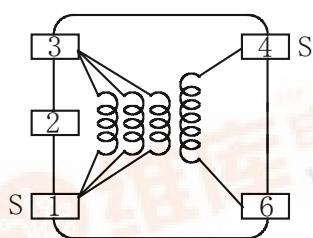

“S” is winding start.

◆ Land Pattern (mm)

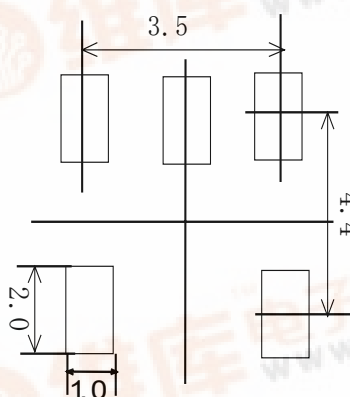

◆ Specification

Sample No.	Inductance (4-6) 1kHz/1V	D.C.R (1-3) @ 20℃
6309-T004	63μH ± 20%	300mΩ Max.