

CRYSTAL RESONATOR

LEAD TYPE

SMD-49 TYPE



Dimension (mm):

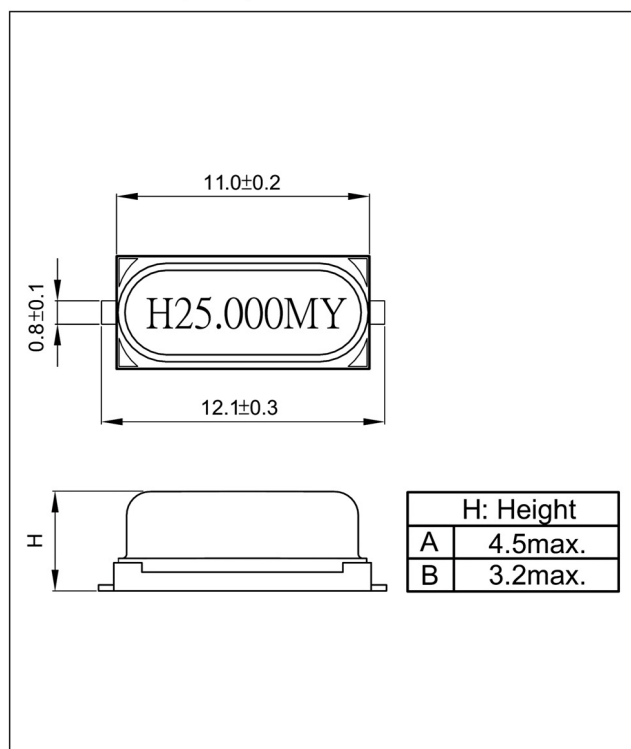

Features:

- This series applies reliable resistance-weld sealing which ensure high specification performance.
- Height can be custom designed according to customer requirement.
- High reliability against shock and vibration.
- Ideal solution for DIP clock design looking to switch to SMD production without drastic changes

Recommended Land Pattern (mm)

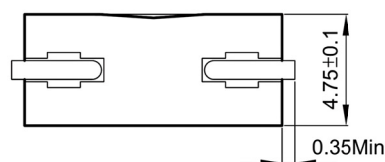

Recommended Land Pattern (mm)

<Top View>

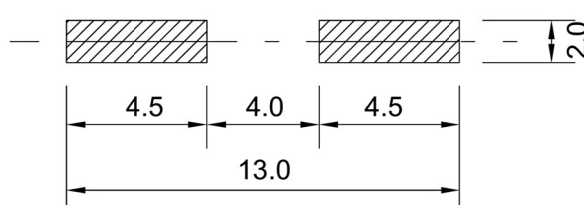

Standard Specification:

TEM	TYPE	SMD-49	FREQUENCY	Mode	RR/SERIES
Frequency Range		A	3.0 ~ 3.6 MHz	Fund.	150ΩMax.
		B			
Oscillation Mode	Thickness Shear Mode	3.0 ~ 75 MHz	6.0~75MHz	Fund.	100ΩMax.
Frequency Tolerance (at 25℃)		Fundamental; 3rd Overtone	3.7 ~ 4.2 MHz	Fund.	80ΩMax.
Frequency Stability Over Operating Temperature Range (Ref. to 25℃)		±30ppm, ±50ppm, ±100ppm, or specify	4.3 ~ 6.0 MHz	Fund.	60ΩMax.
Operating Temperature Range		±30ppm, ±50ppm, ±100ppm (standard), or specify	6.1 ~ 10.0 MHz	Fund.	50ΩMax.
Drive Level (DL)		-10 ~ +60℃	10.1 ~ 14.0 MHz	Fund.	40ΩMax.
Load Capacitance (CL)		100μW Typ, or specify	14.1 MHz ~	Fund.	40ΩMax.
Storage Temperature Range		Series, 12pF, 16pF, 20pF, 32pF (Fund.) or specify. 8pF, 10pF, 12pF, 16pF (3rd) or specify	26.0 ~ 29.0 MHz	Fund.	150ΩMax.
Aging (at 25℃)				3rd.	40ΩMax.
				Fund.	100ΩMax.
				3rd.	80ΩMax.

*Packing Unit: 1,000pcs/Reel.