

Main Feature

1. Small size with slim width.
2. SPST and SPDT Contact forms are available.
3. Contact Capacity is 10A.
4. Surge Strength can be up to 8000V.



Contact Rating

Load Type	JQ (DM/TM/LM)	JQ (D/T/L)
Rated Load (Resistive)	10A 125VAC	NO:10A 125VAC
	5A 250VAC	5A 250VAC
	5A 30VDC	5A 30VDC
	-	NC: 5A 125VAC
	-	3A 250VAC
Rated Carrying Current	5A	5A
Max. Allowable Voltage	AC 250V	AC 250V
	DC 30V	DC 30V
Max. Allowable Current	10A	10A
Max. Allowable Power Force	1,250VA	1,250VA
	300W	300W
Contact Material	Ag Alloy	Ag Alloy
Contact Form	SPST	SPDT

Application

Air Conditioner, Fan Control, Home Appliances, Timer, and Thermal Control Application.

Performance (at Initial Value)

- Contact Resistance 100mΩMax. @1A,6VDC
- Operate Time..... 6 mSec. Max.
- Release Time 2 mSec. Max.
- Dielectric Strength :
Between Coil & Contact 4,000VAC at 50/60 Hz for one minute.
Between Contacts 1,000VAC at 50/60 Hz for one minute.
- Surge Strength 8,000V (between coil & contact 1.2x50μSec.)
- Insulation Resistance 100 MegaΩ Min.at 500VDC.
- Max. On/Off Switching :
Electrical..... 6 Cycles per Minute.
Mechanical 300 Cycles per Minute.
- Temperature Range..... -40~70°C.
- Humidity Range 45~85% RH
- Coil Temperature Rise 45°C Max.
- Vibration :
Endurance 10 to 55 Hz dual.
amplitude width 1.5mm.
Error Operation..... 10 to 55 Hz dual.
amplitude width 1.5mm.
- Shock :
Endurance 1,000 m/S².
Error Operation..... 100 m/S².
- Life Expectancy :
Mechanical 10⁷ Operations at No Load condition.
Electrical 10⁵ Operations at Rated Resistive Load.
- Weight About 5.6g.

Safety Standard & Its File Number

- C-UL E141060
- TÜV R3-50008011
- VDE 40010922

Coil Specification (at 20°C)

Coil Sensitivity	Nominal Voltage (VDC)	Nominal Current (mA)	Coil Resistance ($\Omega \pm 10\%$)	Power Consumption (W)	Pull-In Voltage (VDC)	Drop-Out Voltage (VDC)	Maximum Allowable Voltage (VDC)
JQ-D/DM	3	150	20	Abt. 0.45	75% Maximum	5% Minimum	120%
	5	91	55				
	6	75	80				
	9	50	180				
	12	37.5	320				
	24	18.8	1,280				
JQ-T/TM	3	133.3	22.5	Abt.0.4			
	5	80	62.5				
	6	66.7	90				
	9	44.4	202				
	12	33.3	360				
	24	16.7	1,440				
JQ-LM	3	67	45	Abt.0.2			
	5	40	125				
	6	33.3	180				
	9	22.5	400				
	12	16.7	720				
	24	8.3	2,800				

Ordering Information

JQ - SS - 1 12 D M

Contact Form:

Nil: One Form C (for D Type Only)

M: One Form A (for D,L Type Only)

D: Standard DC Coil

T: Middle Consumption DC Coil

L: High Sensitivity DC Coil

1: One Pole

Coil Voltage:

03: 3V, 05: 5V, 06: 6V, 09: 9V, 12: 12V, 24: 24V

Number of Pole:

Type of Sealing:

SS: Flow Solder Type

SH: Plastic Sealed Type

Type:

JQ

Classification

Model	JQ				
Contact Form	1C		1A		
Coil Type	Standard DC Coil	Middle Consumption	Standard DC Coil	Middle Consumption	High Sensitivity DC
Flow Solder Type	JQ-SS-1□□D	JQ-SS-1□□T	JQ-SS-1□□DM	JQ-SS-1□□TM	JQ-SS-1□□LM
Plastic Sealed Type	JQ-SH-1□□D	JQ-SH-1□□T	JQ-SH-1□□DM	JQ-SH-1□□TM	JQ-SH-1□□LM

Dimension ($\leq 5\text{mm} \pm 0.2\text{mm}$, $> 5\text{mm} \pm 0.3\text{mm}$, the tolerance of PCB thru hole: $+0.1\text{mm}$)

JQ-SS/SH-DM

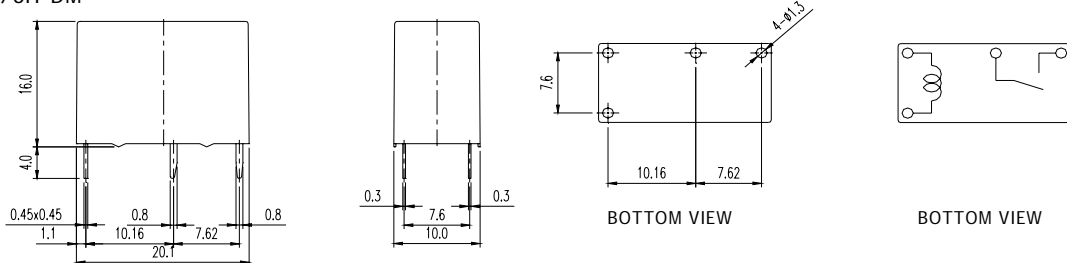

JQ-SS/SH-D

