

PCB LAYOUT

SPECIFICATIONS
 Current Rating: 3Amps
 Insulator resistance: 5000 Megchms min.
 Dielectric Withstanding: AC 500V
 Operating Temperature: -40 ° C to +105 ° C
 Contact Material : Brass
 Insulator Material : PBT
 Unspecified tolerance: ±0.20

Dimensions List

Contacts	Dimensions		Contacts	Dimensions	
	A	B		A	B
2*1	2.54	0	2*21	53.34	50.80
2*2	5.08	2.54	2*22	55.88	53.34
2*3	7.62	5.08	2*23	58.42	55.88
2*4	10.16	7.62	2*24	60.96	58.42
2*5	12.70	10.16	2*25	63.50	60.96
2*6	15.24	12.70	2*26	66.04	63.50
2*7	17.78	15.24	2*27	68.58	66.04
2*8	20.32	17.78	2*28	71.12	68.58
2*9	22.86	20.32	2*29	73.66	71.12
2*10	25.40	22.86	2*30	76.20	73.66
2*11	27.94	25.40	2*31	78.74	76.20
2*12	30.48	27.94	2*32	81.28	78.74
2*13	33.02	30.48	2*33	83.82	81.28
2*14	35.56	33.02	2*34	86.36	83.82
2*15	38.10	35.56	2*35	88.90	86.36
2*16	40.64	38.10	2*36	91.44	88.90
2*17	43.18	40.64	2*37	93.98	91.44
2*18	45.72	43.18	2*38	96.52	93.98
2*19	48.26	45.72	2*39	99.06	96.52
2*20	50.80	48.26	2*40	101.6	99.06

FEMALE HEADER PITCH2.54*8.5mm SINGLE BASE, DUAL ROW

深圳市固锐电子有限公司

Customer:	Approval:	Unit	Scale	Date
Drawling:	Check:	mm		06.10.15

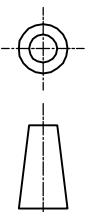

P/NO:
Pin Longer:
Signatuer: