

### GENERAL TECHNICAL CHARACTERISTICS

Dielectric : Polypropylene film  
 Construction : Extended double side metallized carrier film  
 with internal series connection and metallized film  
 Case : Solvent resistant plastic case with resin sealing .  
 Flame retardant execution (UL94V-0 )  
 Leads: Tinned copper wire, 2 leads, 4 leads, 6 leads

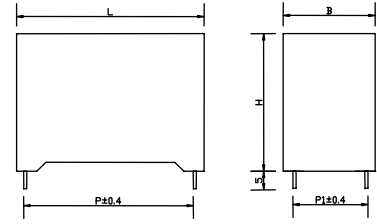

### ELECTRICAL CHARACTERISTICS

Working temperature : - 40 to + 85 °C  
 Capacitance : 0.0047 to 5.6µF  
 Rated Voltage : 700 to 3000 Vdc  
 Tolerance : ± 5%, ± 10%  
 Dissipation factor: Measured at 1000±20 Hz AND 25±5°C.  
 When Cr≤1.0µF, 4×10<sup>-4</sup>;  
 When Cr>1.0µF, 6×10<sup>-4</sup>

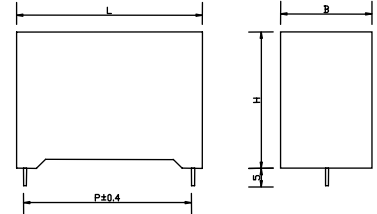

### TEST METHODS AND PERFORMANCES

Dielectric strength: 2Ur (DC) applied for 10s at 25±5°C  
 (1 minute for type test)  
 Insulation resistance : 3000s but need not exceed 30GΩ  
 (typical value), after 1 minute of  
 electrification at 100Vdc (25±5°C)

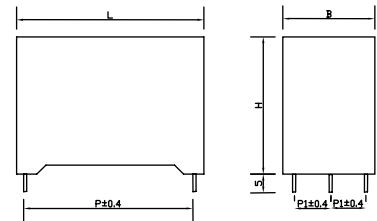

### Electrical specifications, ordering codes

Part Number	Cap (µF)	Dimension (mm)						du/dt (v/µs)	Ipeak (A)	Irms (A)	ESR (mΩ)
		L	T	H	P	P1	d				
Ur 700Vdc, Urms 380Vac, Upk 1000Vdc											
STC-700-0.10-2	0.10	26.5	8.5	17.0	22.5		0.8	600	60	3.6	13.0
STC-700-0.15-2	0.15	26.5	10.0	18.5	22.5		0.8	600	90	5	9.3
STC-700-0.22-2	0.22	26.5	11.0	20.0	22.5		0.8	600	132	6.5	7.0
STC-700-0.22-2	0.22	31.0	11.0	20.0	27.5		1.0	485	107	6.5	7.8
STC-700-0.33-2	0.33	31.0	13.0	22.0	27.5		1.0	485	160	8.5	5.9
STC-700-0.47-2	0.47	31.0	15.0	24.5	27.5		1.0	485	228	9	4.6
STC-700-0.68-2	0.68	31.0	17.0	28.0	27.5		1.2	485	330	12	3.7
STC-700-0.68-4	0.68	31.0	17.0	28.0	27.5	5.1	1.2	485	330	16	3.1
STC-700-0.82-4	0.82	31.0	17.0	28.0	27.5	10.2	1.2	485	398	12	3.2
STC-700-0.82-2	0.82	42.5	15.0	26.0	37.5		1.2	325	267	12	3.4
STC-700-1.0-2	1.0	31.0	22.0	31.0	27.5		1.2	485	485	12	3.2
STC-700-1.0-4	1.0	31.0	22.0	31.0	27.5	10.2	1.2	485	485	19	2.6
STC-700-1.0-2	1.0	42.5	17.0	28.0	37.5		1.2	325	325	12	3.3
STC-700-1.5-2	1.5	42.5	22.0	30.0	37.5		1.2	325	488	12	3.2
STC-700-1.5-4	1.5	42.5	22.0	30.0	37.5	10.2	1.2	325	488	19	3.4
STC-700-2.0-2	2.0	42.5	28.0	37.0	37.5		1.2	325	650	12	3.0
STC-700-2.0-4	2.0	42.5	28.0	37.0	37.5	10.2	1.2	325	650	22	2.9
STC-700-2.2-2	2.2	42.5	28.0	37.0	37.5		1.2	325	715	12	2.8
STC-700-2.2-4	2.2	42.5	28.0	37.0	37.5	20.3	1.2	325	715	22	2.5
STC-700-3.0-2	3.0	42.5	30.0	45.0	37.5		1.2	325	975	12	2.6
STC-700-3.0-4	3.0	42.5	30.0	45.0	37.5	20.3	1.2	325	975	22	2.4
STC-700-3.0-6	3.0	42.5	30.0	45.0	37.5	10.2	1.2	325	975	27	2.2
STC-700-3.3-2	3.3	42.5	30.0	45.0	37.5		1.2	325	1073	12	2.5
STC-700-3.3-4	3.3	42.5	30.0	45.0	37.5	20.3	1.2	325	1073	22	2.4
STC-700-3.3-6	3.3	42.5	30.0	45.0	37.5	10.2	1.2	325	1073	27	2.1
STC-700-4.0-2	4.0	42.5	33.0	45.0	37.5		1.2	325	1300	13	2.1
STC-700-4.0-4	4.0	42.5	33.0	45.0	37.5	20.3	1.2	325	1300	23	2.0
STC-700-4.0-6	4.0	42.5	33.0	45.0	37.5	10.2	1.2	325	1300	28	1.9
STC-700-4.0-2	4.0	57.5	30.0	45.0	52.5		1.2	200	800	12	3.0
STC-700-4.0-4	4.0	57.5	30.0	45.0	52.5	20.3	1.2	200	800	22	2.4

### Electrical specifications, ordering codes

Part Number	Cap (µF)	Dimension (mm)						du/dt (v/µs)	Ipeak (A)	Irms (A)	ESR (mΩ)
		L	T	H	P	P1	d				
STC-700-4.0-6	4.0	57.5	30.0	45.0	52.5	10.2	1.2	200	800	27	2.4
STC-700-4.7-2	4.7	57.5	30.0	45.0	52.5		1.2	200	940	12	3.0
STC-700-4.7-4	4.7	57.5	30.0	45.0	52.5	20.3	1.2	200	940	22	2.8
STC-700-4.7-6	4.7	57.5	30.0	45.0	52.5	10.2	1.2	200	940	31	2.6
STC-700-5.0-2	5.0	57.5	30.0	45.0	52.5		1.2	200	1000	12	2.9
STC-700-5.0-4	5.0	57.5	30.0	45.0	52.5	20.3	1.2	200	1000	22	2.7
STC-700-5.0-6	5.0	57.5	30.0	45.0	52.5	10.2	1.2	200	1000	31	2.6
STC-700-5.6-2	5.6	57.5	35.0	50.0	52.5		1.2	200	1120	12	2.7
STC-700-5.6-4	5.6	57.5	35.0	50.0	52.5	20.3	1.2	200	1120	22	2.5
STC-700-5.6-6	5.6	57.5	35.0	50.0	52.5	10.2	1.2	200	1120	31	2.4
<b>Ur 850Vdc, Urms 450Vac, Upk 1200Vdc</b>											
STC-850-0.68-2	0.068	26.5	8.5	17.0	22.5		0.8	850	58	3.5	13.9
STC-850-0.10-2	0.10	26.5	10.0	18.5	22.5		0.8	850	85	4.5	10.4
STC-850-0.15-2	0.15	26.5	11.0	20.0	22.5		0.8	850	128	6.5	7.5
STC-850-0.15-2	0.15	31.0	11.0	20.0	27.5		0.8	700	105	6.5	8.6
STC-850-0.22-2	0.22	31.0	13.0	22.0	27.5		1.0	700	154	8	6.4
STC-850-0.33-2	0.33	31.0	15.0	24.5	27.5		1.0	700	231	9	4.8
STC-850-0.47-2	0.47	31.0	18.0	33.0	27.5		1.2	700	329	12	3.9
STC-850-0.47-4	0.47	31.0	18.0	33.0	27.5	10.2	1.2	700	329	16	3.3
STC-850-0.56-2	0.56	31.0	18.0	33.0	27.5		1.2	700	392	18	3.1
STC-850-0.56-4	0.56	31.0	18.0	33.0	27.5	10.2	1.2	700	392	12	3.7
STC-850-0.56-2	0.56	42.5	15.0	26.0	37.5		1.2	400	224	12	3.8
STC-850-0.68-2	0.68	31.0	22.0	31.0	27.5		1.2	700	476	12	3.3
STC-850-0.68-4	0.68	31.0	22.0	31.0	27.5	10.2	1.2	700	476	19	2.8
STC-850-0.68-2	0.68	42.5	17.0	28.0	37.5		1.2	400	272	12	3.6
STC-850-1.0-2	1.0	42.5	22.0	30.0	37.5		1.2	400	400	12	3.3
STC-850-1.0-4	1.0	42.5	22.0	30.0	37.5	10.2	1.2	400	400	21	2.7
STC-850-1.5-2	1.5	42.5	28.0	37.0	37.5		1.2	400	600	12	2.8
STC-850-1.5-4	1.5	42.5	28.0	37.0	37.5	20.3	1.2	400	600	22	2.2
STC-850-2.0-2	2.0	42.5	30.0	45.0	37.5		1.2	400	800	12	2.5
STC-850-2.0-4	2.0	42.5	30.0	45.0	37.5	20.3	1.2	400	800	22	1.9
STC-850-2.0-6	2.0	42.5	30.0	45.0	37.5	10.2	1.2	400	800	26	1.9
STC-850-2.2-2	2.2	42.5	30.0	45.0	37.5		1.2	400	880	12	2.5
STC-850-2.2-4	2.2	42.5	30.0	45.0	37.5	20.3	1.2	400	880	22	1.9
STC-850-2.2-6	2.2	42.5	30.0	45.0	37.5	10.2	1.2	400	880	27	1.9
STC-850-2.5-2	2.5	57.5	30.0	45.0	52.5		1.2	275	688	12	2.9
STC-850-2.5-4	2.5	57.5	30.0	45.0	52.5	20.3	1.2	275	688	22	2.3
STC-850-2.5-6	2.5	57.5	30.0	45.0	52.5	10.2	1.2	275	688	27	2.3
STC-850-3.0-2	3.0	57.5	30.0	45.0	52.5		1.2	275	825	12	2.7
STC-850-3.0-4	3.0	57.5	30.0	45.0	52.5	20.3	1.2	275	825	22	2.1
STC-850-3.0-6	3.0	57.5	30.0	45.0	52.5	10.2	1.2	275	825	27	2.1
STC-850-3.3-2	3.3	57.5	30.0	45.0	52.5		1.2	275	908	12	2.7
STC-850-3.3-4	3.3	57.5	30.0	45.0	52.5	20.3	1.2	275	908	22	2.1
STC-850-3.3-6	3.3	57.5	30.0	45.0	52.5	10.2	1.2	275	908	29	2.1
STC-850-4.0-2	4.0	57.5	35.0	50.0	52.5		1.2	275	1100	12	2.5
STC-850-4.0-4	4.0	57.5	35.0	50.0	52.5	20.3	1.2	275	1100	22	1.9
STC-850-4.0-6	4.0	57.5	35.0	50.0	52.5	10.2	1.2	275	1100	28	1.8
STC-850-4.7-2	4.7	57.5	35.0	50.0	52.5		1.2	275	1293	12	2.3
STC-850-4.7-4	4.7	57.5	35.0	50.0	52.5	20.3	1.2	275	1293	22	1.8
STC-850-4.7-6	4.7	57.5	35.0	50.0	52.5	10.2	1.2	275	1293	30	1.5
<b>Ur 1000Vdc, Urms 480Vac, Upk 1400Vdc</b>											
STC-1000-0.047-2	0.047	26.5	7.0	16.0	22.5		0.8	1000	47	3	18.0
STC-1000-0.068-2	0.068	26.5	8.5	17.0	22.5		0.8	1000	68	2.3	13.5

### Electrical specifications, ordering codes

Part Number	Cap (μF)	Dimension (mm)						du/dt (v/μs)	Ipeak (A)	Irms (A)	ESR (mΩ)
		L	T	H	P	P1	d				
STC-1000-0.10-2	0.10	26.5	11.0	20.0	22.5		0.8	1000	100	5	9.9
STC-1000-0.10-2	0.10	31.0	9.0	18.0	27.5		0.8	850	85	5	11.0
STC-1000-0.15-2	0.15	26.5	12.0	22.0	22.5		0.8	1000	150	6.5	7.3
STC-1000-0.15-2	0.15	31.0	11.0	20.0	27.5		0.8	850	128	6.5	8.2
STC-1000-0.22-2	0.22	31.0	15.0	24.5	27.5		1.0	850	187	9	6.5
STC-1000-0.33-2	0.33	31.0	17.0	28.0	27.5		1.0	850	281	9	5.5
STC-1000-0.47-2	0.47	31.0	18.0	33.0	27.5		1.2	850	400	12	3.7
STC-1000-0.47-4	0.47	31.0	18.0	33.0	27.5	10.2	1.2	850	400	16	3.1
STC-1000-0.47-2	0.47	42.5	17.0	28.0	37.5		1.2	570	268	12	4.6
STC-1000-0.56-2	0.56	42.5	17.0	28.0	37.5		1.2	570	319	12	4.2
STC-1000-0.68-2	0.68	42.5	22.0	30.0	37.5		1.2	570	388	12	3.9
STC-1000-0.68-4	0.68	42.5	22.0	30.0	37.5	10.2	1.2	570	388	19	3.3
STC-1000-0.82-2	0.82	42.5	22.0	30.0	37.5		1.2	570	467	12	3.6
STC-1000-0.82-4	0.82	42.5	22.0	30.0	37.5	10.2	1.2	570	467	22	3.2
STC-1000-1.0-2	1.0	42.5	28.0	37.0	37.5		1.2	570	570	12	3.4
STC-1000-1.0-4	1.0	42.5	28.0	37.0	37.5	10.2	1.2	570	570	22	2.7
STC-1000-1.2-2	1.2	42.5	28.0	37.0	37.5		1.2	570	684	12	3.3
STC-1000-1.2-4	1.2	42.5	28.0	37.0	37.5	10.2	1.2	570	684	22	2.9
STC-1000-1.5-2	1.5	42.5	30.0	45.0	37.5		1.2	570	855	12	2.9
STC-1000-1.5-4	1.5	42.5	30.0	45.0	37.5	20.3	1.2	570	855	22	2.2
STC-1000-1.5-6	1.5	42.5	30.0	45.0	37.5	10.2	1.2	570	855	22.5	2.2
STC-1000-2.0-2	2.0	42.5	33.0	45.0	37.5		1.2	570	1140	11	3.1
STC-1000-2.0-4	2.0	42.5	33.0	45.0	37.5	20.3	1.2	570	1140	21	2.7
STC-1000-2.0-6	2.0	42.5	33.0	45.0	37.5	10.2	1.2	570	1140	26	2.5
STC-1000-2.0-2	2.0	57.5	30.0	45.0	52.5		1.2	320	640	12	3.0
STC-1000-2.0-4	2.0	57.5	30.0	45.0	52.5	20.3	1.2	320	640	22	2.6
STC-1000-2.0-6	2.0	57.5	30.0	45.0	52.5	10.2	1.2	320	640	27	2.6
STC-1000-2.2-2	2.2	57.5	30.0	45.0	52.5		1.2	320	704	12	2.6
STC-1000-2.2-4	2.2	57.5	30.0	45.0	52.5	20.3	1.2	320	704	22	3.1
STC-1000-2.2-6	2.2	57.5	30.0	45.0	52.5	10.2	1.2	320	704	26	2.5
STC-1000-3.0-2	3.0	57.5	35.0	50.0	52.5		1.2	320	960	12	2.7
STC-1000-3.0-4	3.0	57.5	35.0	50.0	52.5	20.3	1.2	320	960	22	2.2
STC-1000-3.0-6	3.0	57.5	35.0	50.0	52.5	10.2	1.2	320	960	29	2.2
STC-1000-3.3-2	3.3	57.5	35.0	50.0	52.5		1.2	320	1056	12	2.6
STC-1000-3.3-4	3.3	57.5	35.0	50.0	52.5	20.3	1.2	320	1056	22	2.0
STC-1000-3.3-6	3.3	57.5	35.0	50.0	52.5	10.2	1.2	320	1056	30	2.0
<b>Ur 1200Vdc, Urms 500Vac, Upk 1600Vdc</b>											
STC-1200-0.033-2	0.033	26.5	7.0	16.0	22.5		0.8	1300	43	3	22.0
STC-1200-0.047-2	0.047	26.5	8.5	17.0	22.5		0.8	1300	61	3.5	16.0
STC-1200-0.068-2	0.068	26.5	10.0	18.5	22.5		0.8	1300	88	4	13.0
STC-1200-0.068-2	0.068	31.0	9.0	18.0	27.5		0.8	1100	75	4	14.0
STC-1200-0.10-2	0.10	26.5	12.0	22.0	22.5		0.8	1300	130	5.5	9.7
STC-1200-0.10-2	0.10	31.0	11.0	20.0	27.5		0.8	1100	110	5.5	10.5
STC-1200-0.15-2	0.15	31.0	13.0	22.0	27.5		1.0	1100	165	7	7.6
STC-1200-0.22-2	0.22	31.0	15.0	24.5	27.5		1.0	1100	242	9	5.5
STC-1200-0.33-2	0.33	31.0	18.0	33.0	27.5		1.2	1100	363	12	4.3
STC-1200-0.33-4	0.33	31.0	18.0	33.0	27.5	10.2	1.2	1100	363	15.5	3.7
STC-1200-0.33-2	0.33	42.5	15.0	26.0	37.5		1.2	650	215	12	5.5
STC-1200-0.47-2	0.47	31.0	22.0	31.0	27.5		1.2	1100	517	12	3.4
STC-1200-0.47-4	0.47	31.0	22.0	31.0	27.5	10.2	1.2	1100	517	19	2.8
STC-1200-0.47-2	0.47	42.5	17.0	28.0	37.5		1.2	650	306	12	4.8
STC-1200-0.68-2	0.68	42.5	22.0	30.0	37.5		1.2	650	442	12	3.9
STC-1200-0.68-4	0.68	42.5	22.0	30.0	37.5	10.2	1.2	650	442	20	3.4

### Electrical specifications, ordering codes

Part Number	Cap (μF)	Dimension (mm)						du/dt (v/μs)	Ipeak (A)	Irms (A)	ESR (mΩ)
		L	T	H	P	P1	d				
STC-1200-1.0-2	1.0	42.5	28.0	37.0	37.5		1.2	650	650	12	3.4
STC-1200-1.0-4	1.0	42.5	28.0	37.0	37.5	20.3	1.2	650	650	21	2.8
STC-1200-1.2-2	1.2	42.5	28.0	37.0	37.5		1.2	650	780	12	3.4
STC-1200-1.2-4	1.2	42.5	28.0	37.0	37.5	20.3	1.2	650	780	22	2.5
STC-1200-1.5-2	1.5	42.5	30.0	45.0	37.5		1.2	650	975	12	2.8
STC-1200-1.5-4	1.5	42.5	30.0	45.0	37.5	20.3	1.2	650	975	22	2.1
STC-1200-1.5-6	1.5	42.5	30.0	45.0	37.5	10.2	1.2	650	975	27	2.1
STC-1200-2.0-2	2.0	57.5	30.0	45.0	52.5		1.2	350	700	12	3.0
STC-1200-2.0-4	2.0	57.5	30.0	45.0	52.5	20.3	1.2	350	700	22	2.4
STC-1200-2.0-6	2.0	57.5	30.0	45.0	52.5	10.2	1.2	350	700	27	2.4
STC-1200-2.2-2	2.2	57.5	30.0	50.0	52.5		1.2	350	770	12	2.9
STC-1200-2.2-4	2.2	57.5	30.0	50.0	52.5	20.3	1.2	350	770	22	2.3
STC-1200-2.2-6	2.2	57.5	30.0	50.0	52.5	10.2	1.2	350	770	30	2.3
STC-1200-2.5-2	2.5	57.5	35.0	50.0	52.5		1.2	350	875	12	2.7
STC-1200-2.5-4	2.5	57.5	35.0	50.0	52.5	20.3	1.2	350	875	22	2.1
STC-1200-2.5-6	2.5	57.5	35.0	50.0	52.5	10.2	1.2	350	875	30	2.1
STC-1200-3.0-2	3.0	57.5	35.0	50.0	52.5		1.2	350	1050	12	2.3
STC-1200-3.0-4	3.0	57.5	35.0	50.0	52.5	20.3	1.2	350	1050	22	2.0
STC-1200-3.0-6	3.0	57.5	35.0	50.0	52.5	10.2	1.2	350	1050	29	2.0
<b>Ur 1500Vdc, Urms 570Vac, Upk 2000Vdc</b>											
STC-1500-0.022-2	0.022	26.5	7.0	16.0	22.5		0.8	1500	33	2.5	29.5
STC-1500-0.033-2	0.033	26.5	8.5	17.0	22.5		0.8	1500	50	3	22.0
STC-1500-0.047-2	0.047	26.5	10.0	18.5	22.5		0.8	1500	71	3.5	16.5
STC-1500-0.047-2	0.047	31.0	9.0	18.0	27.5		0.8	1225	58	3.5	18.2
STC-1500-0.068-2	0.068	26.5	12.0	22.0	22.5		0.8	1500	102	5	12.3
STC-1500-0.068-2	0.068	31.0	11.0	20.0	27.5		0.8	1225	83	5	13.8
STC-1500-0.10-2	0.10	31.0	13.0	22.0	27.5		0.8	1225	123	6.5	9.5
STC-1500-0.15-2	0.15	31.0	17.0	28.0	27.5		1.0	1225	184	8	7.1
STC-1500-0.22-2	0.22	31.0	18.0	33.0	27.5		1.2	1225	270	12	5.1
STC-1500-0.22-2	0.22	42.5	17.0	28.0	37.5		1.2	800	176	12	6.8
STC-1500-0.33-2	0.33	42.5	22.0	30.0	37.5		1.2	800	264	12	4.1
STC-1500-0.33-4	0.33	42.5	22.0	30.0	37.5	10.2	1.2	800	264	18	3.3
STC-1500-0.39-2	0.39	42.5	22.0	30.0	37.5		1.2	800	312	12	4.0
STC-1500-0.39-4	0.39	42.5	22.0	30.0	37.5	10.2	1.2	800	312	18	3.1
STC-1500-0.47-2	0.47	42.5	28.0	37.0	37.5		1.2	800	376	12	4.4
STC-1500-0.47-4	0.47	42.5	28.0	37.0	37.5	10.2	1.2	800	376	22	3.8
STC-1500-0.68-2	0.68	42.5	28.0	37.0	37.5		1.2	800	544	12	3.8
STC-1500-0.68-4	0.68	42.5	28.0	37.0	37.5	10.2	1.2	800	544	22	3.2
STC-1500-1.0-2	1.0	42.5	30.0	45.0	37.5		1.2	800	800	12	3.2
STC-1500-1.0-4	1.0	42.5	30.0	45.0	37.5	20.3	1.2	800	800	22	2.6
STC-1500-1.2-2	1.2	57.5	30.0	45.0	52.5		1.2	500	600	12	3.5
STC-1500-1.2-4	1.2	57.5	30.0	45.0	52.5	20.3	1.2	500	600	22	2.9
STC-1500-1.2-6	1.2	57.5	30.0	45.0	52.5	10.2	1.2	500	600	27	2.9
STC-1500-1.5-2	1.5	57.5	35.0	50.0	52.5		1.2	500	750	12	3.2
STC-1500-1.5-4	1.5	57.5	35.0	50.0	52.5	20.3	1.2	500	750	22	2.6
STC-1500-1.5-6	1.5	57.5	35.0	50.0	52.5	10.2	1.2	500	750	27	2.6
STC-1500-1.8-2	1.8	57.5	35.0	50.0	52.5		1.2	500	900	12	3.0
STC-1500-1.8-4	1.8	57.5	35.0	50.0	52.5	20.3	1.2	500	900	22	2.4
STC-1500-1.8-6	1.8	57.5	35.0	50.0	52.5	10.2	1.2	500	900	30	2.4
<b>Ur 2000Vdc, Urms 630Vac, Upk 2400Vdc</b>											
STC-2000-0.015-2	0.015	26.5	7.0	16.0	22.5		0.8	2150	32	2	37.5
STC-2000-0.022-2	0.022	26.5	8.5	17.0	22.5		0.8	2150	47	2.5	27.0

### Electrical specifications, ordering codes

Part Number	Cap (µF)	Dimension (mm)						Du/dt (v/µs)	Ipeak (A)	Irms (A)	ESR (mΩ)
		L	T	H	P	P1	d				
STC-2000-0.033-2	0.033	26.5	11.0	20.0	22.5		0.8	2150	71	3.5	21.0
STC-2000-0.033-2	0.033	31.0	11.0	20.0	27.5		0.8	1750	58	4	23.7
STC-2000-0.047-2	0.047	26.5	12.0	22.0	22.5		0.8	2150	101	4.5	14.8
STC-2000-0.047-2	0.047	31.0	11.0	20.0	27.5		0.8	1750	82	4.5	16.8
STC-2000-0.068-2	0.068	31.0	13.0	22.0	27.5		0.8	1750	119	5.5	12.1
STC-2000-0.10-2	0.10	31.0	17.0	28.0	27.5		1.0	1750	175	8	8.4
STC-2000-0.15-2	0.15	31.0	18.0	33.0	27.5		1.2	1750	263	11	6.5
STC-2000-0.15-4	0.15	31.0	18.0	33.0	27.5	10.2	1.2	1750	263	12	5.9
STC-2000-0.15-2	0.15	42.5	15.0	26.0	37.5		1.2	1000	150	9	8.0
STC-2000-0.22-2	0.22	42.5	22.0	30.0	37.5		1.2	1000	220	12	5.2
STC-2000-0.33-2	0.33	42.5	28.0	37.0	37.5		1.2	1000	330	12	4.7
STC-2000-0.33-4	0.33	42.5	28.0	37.0	37.5	10.2	1.2	1000	330	18	3.1
STC-2000-0.39-2	0.39	42.5	28.0	37.0	37.5		1.2	1000	390	12	4.7
STC-2000-0.39-4	0.39	42.5	28.0	37.0	37.5	20.3	1.2	1000	390	19	3.0
STC-2000-0.47-2	0.47	42.5	28.0	37.0	37.5		1.2	1000	470	12	4.0
STC-2000-0.47-4	0.47	42.5	28.0	37.0	37.5	20.3	1.2	1000	470	22	3.4
STC-2000-0.56-2	0.56	42.5	30.0	45.0	37.5		1.2	1000	560	12	3.7
STC-2000-0.56-4	0.56	42.5	30.0	45.0	37.5	20.3	1.2	1000	560	22	3.1
STC-2000-0.56-6	0.56	42.5	33.0	45.0	37.5	10.2	1.2	1000	560	27	3.1
STC-2000-0.68-2	0.68	42.5	33.0	45.0	37.5		1.2	1000	680	12	3.7
STC-2000-0.68-4	0.68	42.5	33.0	45.0	37.5	20.3	1.2	1000	680	22	3.1
STC-2000-0.68-6	0.68	42.5	33.0	45.0	37.5	10.2	1.2	1000	680	28	3.0
STC-2000-0.68-2	0.68	57.5	30.0	45.0	52.5		1.2	580	394	12	4.3
STC-2000-0.68-4	0.68	57.5	30.0	45.0	52.5	20.3	1.2	580	394	22	3.6
STC-2000-0.68-6	0.68	57.5	30.0	45.0	52.5	10.2	1.2	580	394	27	3.6
STC-2000-0.82-2	0.82	57.5	30.0	45.0	52.5		1.2	580	476	12	3.9
STC-2000-0.82-4	0.82	57.5	30.0	45.0	52.5	20.3	1.2	580	476	22	3.2
STC-2000-0.82-6	0.82	57.5	30.0	45.0	52.5	10.2	1.2	580	476	24	3.1
STC-2000-1.0-2	1.0	57.5	35.0	50.0	52.5		1.2	580	580	12	3.6
STC-2000-1.0-4	1.0	57.5	35.0	50.0	52.5	20.3	1.2	580	580	22	2.9
STC-2000-1.0-6	1.0	57.5	35.0	50.0	52.5	10.2	1.2	580	580	29	2.9
STC-2000-1.2-2	1.2	57.5	35.0	50.0	52.5		1.2	580	696	12	3.2
STC-2000-1.2-4	1.2	57.5	35.0	50.0	52.5	20.3	1.2	580	696	22	2.5
STC-2000-1.2-6	1.2	57.5	35.0	50.0	52.5	10.2	1.2	580	696	29	2.5
<b>Ur 2500Vdc, Urms 700Vac, Upk 3000Vdc</b>											
STC-2500-0.0068-2	0.0068	26.5	7.0	16.0	22.5		0.8	2650	18	1.5	68.0
STC-2500-0.010-2	0.010	26.5	8.5	17.0	22.5		0.8	2650	27	2	51.0
STC-2500-0.015-2	0.015	26.5	10.0	18.5	22.5		0.8	2650	40	2.5	36.0
STC-2500-0.022-2	0.022	26.5	12.0	22.0	22.5		0.8	2650	58	3	26.5
STC-2500-0.022-2	0.022	31.0	11.0	20.0	27.5		0.8	2150	47	3	30.5
STC-2500-0.033-2	0.033	31.0	11.0	20.0	27.5		0.8	2150	71	4	22.5
STC-2500-0.047-2	0.047	31.0	13.0	22.0	27.5		0.8	2150	101	5.5	16.0
STC-2500-0.068-2	0.068	31.0	17.0	28.0	27.5		1.0	2150	146	8	11.3
STC-2500-0.10-2	0.10	31.0	18.0	33.0	27.5		1.2	2150	215	10	7.6
STC-2500-0.10-4	0.10	31.0	18.0	33.0	27.5	10.2	1.2	2150	215	11.5	7.0
STC-2500-0.10-2	0.10	42.5	15.0	26.0	37.5		1.2	1350	135	8.5	11.8
STC-2500-0.15-2	0.15	42.5	22.0	30.0	37.5		1.2	1350	203	11	7.7
STC-2500-0.15-4	0.15	42.5	22.0	30.0	37.5	10.2	1.2	1350	203	15	6.5
STC-2500-0.22-2	0.22	42.5	28.0	37.0	37.5		1.2	1350	297	12	5.8
STC-2500-0.22-4	0.22	42.5	28.0	37.0	37.5	10.2	1.2	1350	297	22	5.2
STC-2500-0.33-2	0.33	42.5	28.0	37.0	37.5		1.2	1350	446	12	4.3
STC-2500-0.33-4	0.33	42.5	28.0	37.0	37.5	20.3	1.2	1350	446	20	3.9
STC-2500-0.39-2	0.39	42.5	30.0	45.0	37.5		1.2	1350	527	12	4.3

### Electrical specifications, ordering codes

Part Number	Cap (μF)	Dimension (mm)						du/dt (v/μs)	I <sub>peak</sub> (A)	I <sub>rms</sub> (A)	ESR (mΩ)
		L	T	H	P	P1	d				
STC-2500-0.39-4	0.39	42.5	30.0	45.0	37.5	20.3	1.2	1350	527	20	3.6
STC-2500-0.39-6	0.39	42.5	33.0	45.0	37.5	10.2	1.2	1350	527	25	3.6
STC-2500-0.47-6	0.47	42.5	33.0	45.0	37.5	10.2	1.2	1350	635	25	3.5
STC-2500-0.47-2	0.47	57.5	30.0	45.0	52.5		1.2	750	353	12	4.6
STC-2500-0.47-4	0.47	57.5	30.0	45.0	52.5	20.3	1.2	750	353	22	3.9
STC-2500-0.56-2	0.56	57.5	30.0	45.0	52.5		1.2	750	420	12	4.3
STC-2500-0.56-4	0.56	57.5	30.0	45.0	52.5	20.3	1.2	750	420	22	3.6
STC-2500-0.56-6	0.56	57.5	30.0	45.0	52.5	10.2	1.2	750	420	25	3.6
STC-2500-0.68-2	0.68	57.5	35.0	50.0	52.5		1.2	750	510	12	4.0
STC-2500-0.68-4	0.68	57.5	35.0	50.0	52.5	20.3	1.2	750	510	22	3.3
STC-2500-0.68-6	0.68	57.5	35.0	50.0	52.5	10.2	1.2	750	510	25	3.3
STC-2500-0.82-2	0.82	57.5	35.0	50.0	52.5		1.2	750	615	12	3.7
STC-2500-0.82-4	0.82	57.5	35.0	50.0	52.5	20.3	1.2	750	615	22	2.9
STC-2500-0.82-6	0.82	57.5	35.0	50.0	52.5	10.2	1.2	750	615	26	2.6
<b>Ur 3000Vdc, Urms 750Vac, Upk 3500Vdc</b>											
STC-3000-0.0047-2	0.0047	26.5	7.0	16.0	22.5		0.8	3400	16	1.5	87.0
STC-3000-0.01-2	0.01	26.5	8.5	17.0	22.5		0.8	3400	23	2	64.0
STC-3000-0.01-2	0.01	26.5	11.0	20.0	22.5		0.8	3400	34	2.5	45.6
STC-3000-0.01-2	0.01	31.0	9.0	18.0	27.5		0.8	2750	28	2.5	54.0
STC-3000-0.022-2	0.022	26.5	12.0	22.0	22.5		0.8	3400	51	3	33.0
STC-3000-0.022-2	0.022	31.0	11.0	20.0	27.5		0.8	2750	41	3	38.0
STC-3000-0.022-2	0.022	31.0	13.0	22.0	27.5		0.8	2750	61	4	26.5
STC-3000-0.033-2	0.033	31.0	15.0	24.5	27.5		0.8	2750	91	5	19.0
STC-3000-0.047-2	0.047	31.0	18.0	33.0	27.5		1.0	2750	129	7.5	13.8
STC-3000-0.10-2	0.10	42.5	22.0	30.0	37.5		1.2	1600	160	10	9.4
STC-3000-0.10-4	0.10	42.5	22.0	30.0	37.5	10.2	1.2	1600	160	12.5	8.7
STC-3000-0.15-2	0.15	42.5	28.0	37.0	37.5		1.2	1600	240	12	6.8
STC-3000-0.15-4	0.15	42.5	28.0	37.0	37.5	10.2	1.2	1600	240	14.5	6.1
STC-3000-0.18-4	0.18	42.5	28.0	37.0	37.5	10.2	1.2	1600	288	16	5.8
STC-3000-0.22-2	0.22	42.5	30.0	45.0	37.5		1.2	1600	352	12	5.8
STC-3000-0.22-4	0.22	42.5	30.0	45.0	37.5	20.3	1.2	1600	352	18	4.6
STC-3000-0.22-6	0.22	42.5	33.0	45.0	37.5	10.2	1.2	1600	352	25	6.1
STC-3000-0.24-6	0.24	42.5	33.0	45.0	37.5	10.2	1.2	1600	384	24	5.8
STC-3000-0.27-6	0.27	42.5	33.0	45.0	37.5	10.2	1.2	1600	432	26	5.7
STC-3000-0.33-6	0.33	42.5	33.0	45.0	37.5	10.2	1.2	1600	528	24	5.3
STC-3000-0.33-2	0.33	57.5	30.0	45.0	52.5		1.2	875	289	12	5.7
STC-3000-0.33-4	0.33	57.5	30.0	45.0	52.5	20.3	1.2	875	289	20	6.0
STC-3000-0.35-6	0.35	42.5	33.0	45.0	37.5	10.2	1.2	1600	560	28	3.4
STC-3000-0.47-2	0.47	57.5	33.0	50.0	52.5		1.2	875	411	12	4.8
STC-3000-0.47-4	0.47	57.5	33.0	50.0	52.5	20.3	1.2	875	411	22	3.8

How to Order:

STC- 1200-0.47-2 V L

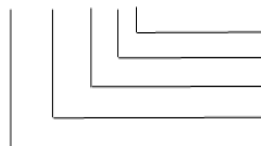

None for 5mm lead length and L for 30mm  
 T for P=22.5, V for P=27.5, F for P=37.5, G for P=52.5  
 Style of capacitor. 2 for 2 leads, 4 for 4 leads, 6 for 6 leads  
 Capacitance  
 Voltage