

R4D500-AT03-01

# AC centrifugal fan

backward curved, single inlet



## Nominal data

Type	R4D500-AT03-01		
Motor	M4D138-HF		
Phase		3~	3~
Nominal voltage	[V]	230	400
Connection		D	Y
Frequency	[Hz]	50	50
Type of data definition		ml	ml
Valid for approval / standard		CE	CE
Speed	[min <sup>-1</sup> ]	1375	1375
Power input	[W]	1430	1430
Current draw	[A]	5.2	3
Min. back pressure	[Pa]	0	0
Max. ambient temperature	[°C]	85	85
Air flow	[m <sup>3</sup> /h]	8320	8320
Back pressure	[Pa]	0	0
Sound pressure level	[dB(A)]	78	78

ml = max. load · me = max. efficiency · rfa = running at free air · cs = customer specs · cu = customer unit  
Subject to alterations

R4D500-AT03-01

# AC centrifugal fan

backward curved, single inlet

## Technical features

Leakage current	<= 3,5 mA
Size	500 mm
Operation mode	S1
Direction of rotation	Clockwise, seen on rotor
Mounting position	Any
Insulation class	"F"
Cable exit	Lateral
Condensate discharge holes	On rotor and stator sides
Bearing motor	Ball bearing
Mass	26.0 kg
Material of impeller	Sheet aluminium, laser-welded
Motor protection	Thermal overload protector (TOP) brought out
Product conforming to standard	CE; EN 61800-5-1
Surface of rotor	Cast in aluminum
Number of blades	9
Type of protection	IP 54
Protection class	I
Max. permissible ambient motor temp. (transp./ storage)	+ 80 °C
Min. permissible ambient motor temp. (transp./storage)	- 40 °C

R4D500-AT03-01

# AC centrifugal fan

backward curved, single inlet

## Product drawing

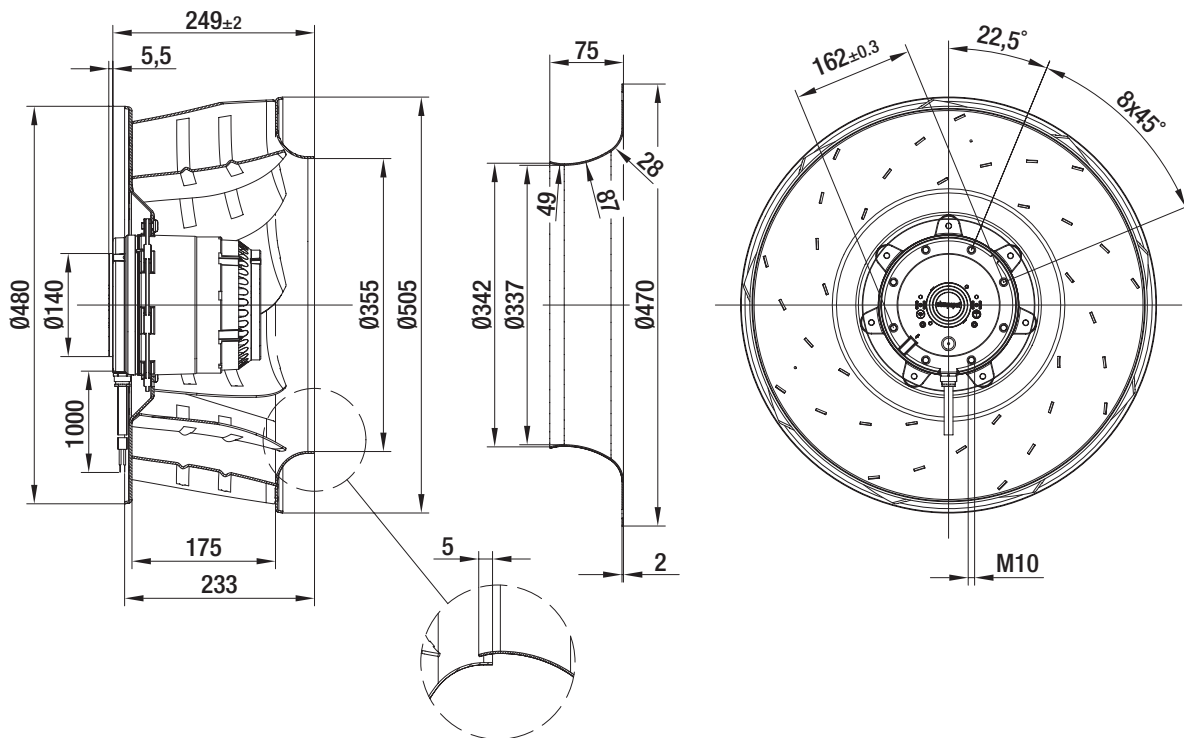

## Connection screen

Delta (3~ 230 VAC)

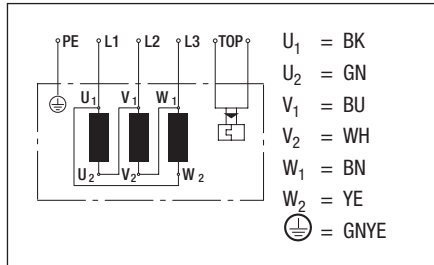

Star (3~ 400 VAC)

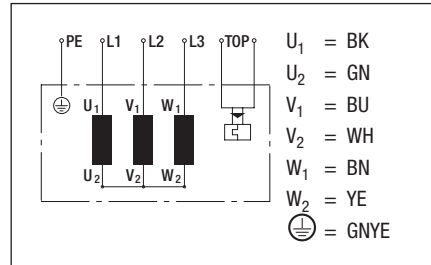

## Charts: Air flow 50 Hz

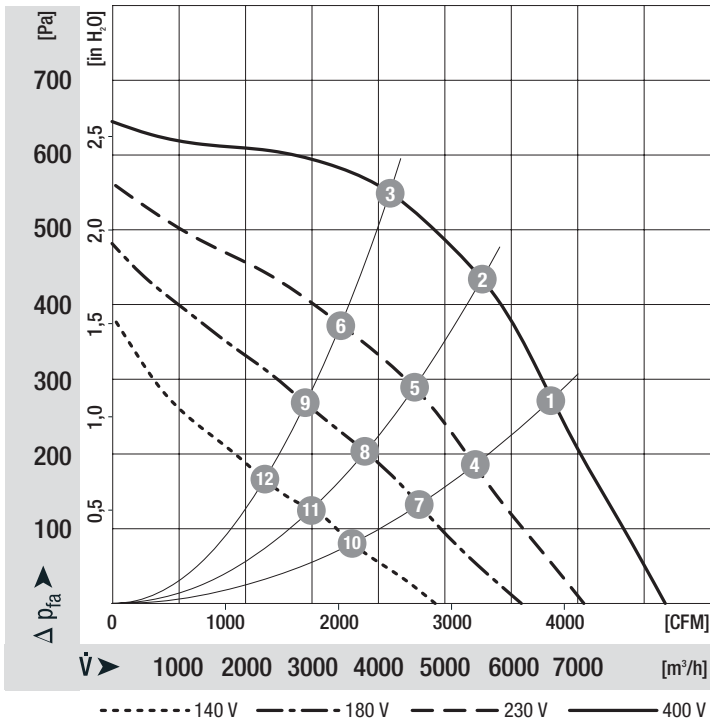

## Measured values

	f	n	P <sub>1</sub>	I	LwA <sub>ss</sub>
	[Hz]	[min <sup>-1</sup> ]	[W]	[A]	[dB(A)]
1	50	1380	1360	2.88	81
2	50	1375	1420	2.96	79
3	50	1375	1430	3.00	77
4	50	1150	970	3.03	76
5	50	1125	1000	3.13	74
6	50	1140	970	3.05	73
7	50	970	730	2.99	71
8	50	945	740	3.06	69
9	50	970	730	2.98	68
10	50	775	490	2.69	64
11	50	755	490	2.73	63
12	50	775	490	2.70	62