

REV	DATE	DESCRIPTON	REVISER
1.0			

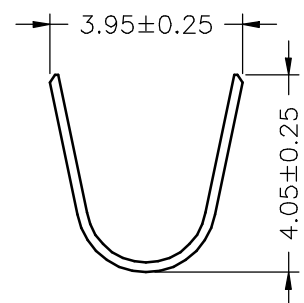

SEC:A-A

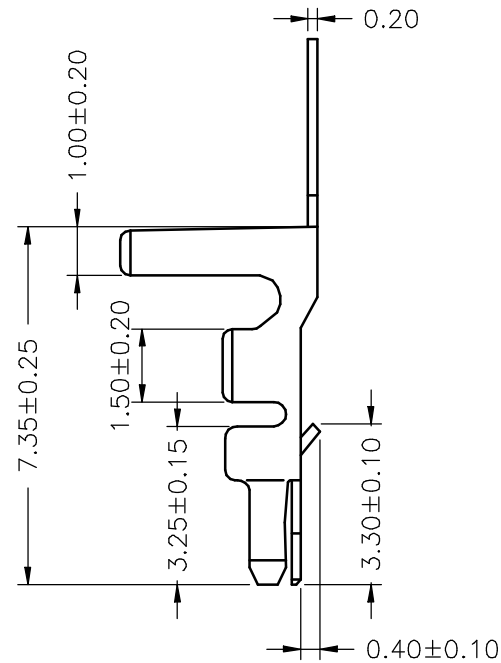
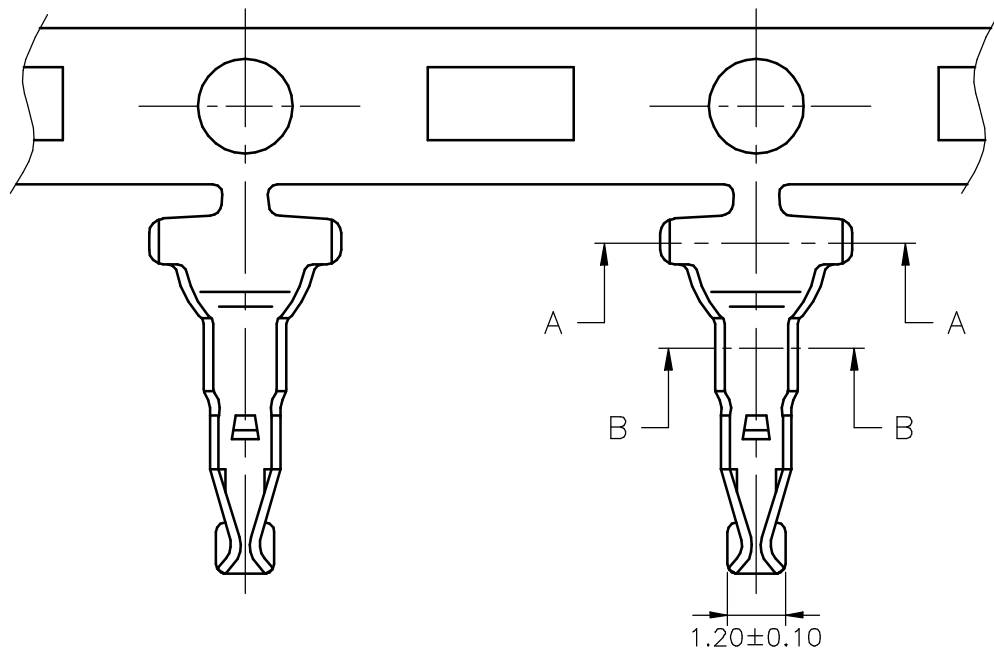
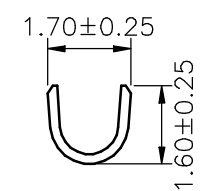

SEC:B-B

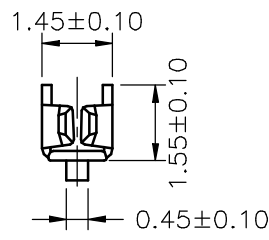

CJT® CHANGJIANG CONNECTORS CO., LTD.
CHANGJIANG CONNECTORS

Ordering information & Specifications

Unit:mm

Part No	Wire Range	Insultion O.D.	Material	Finish	Qty/reel
A4001-TP	AWG# 22-#28	2.40mm(max)	Phosphor Bronze	Tin-plated	5,000 pcs

Note:e-stamping before Tin-plated

Specification

Client:		Drawing No: A4001-T	
Tolerance	Draw By: LIZhiQiang	Date: 2008-05-26	Unit:mm Scale:Enone
X. X ≤ 0.25	Checked: HE.	Date: 2008-05-26	
X. XX ≤ 0.15	Approved:	Date:	
X. XXX ≤ 0.10	Material:	Edition: A	

REV	DATE	DESCRIPTION	REVISOR
1.0			

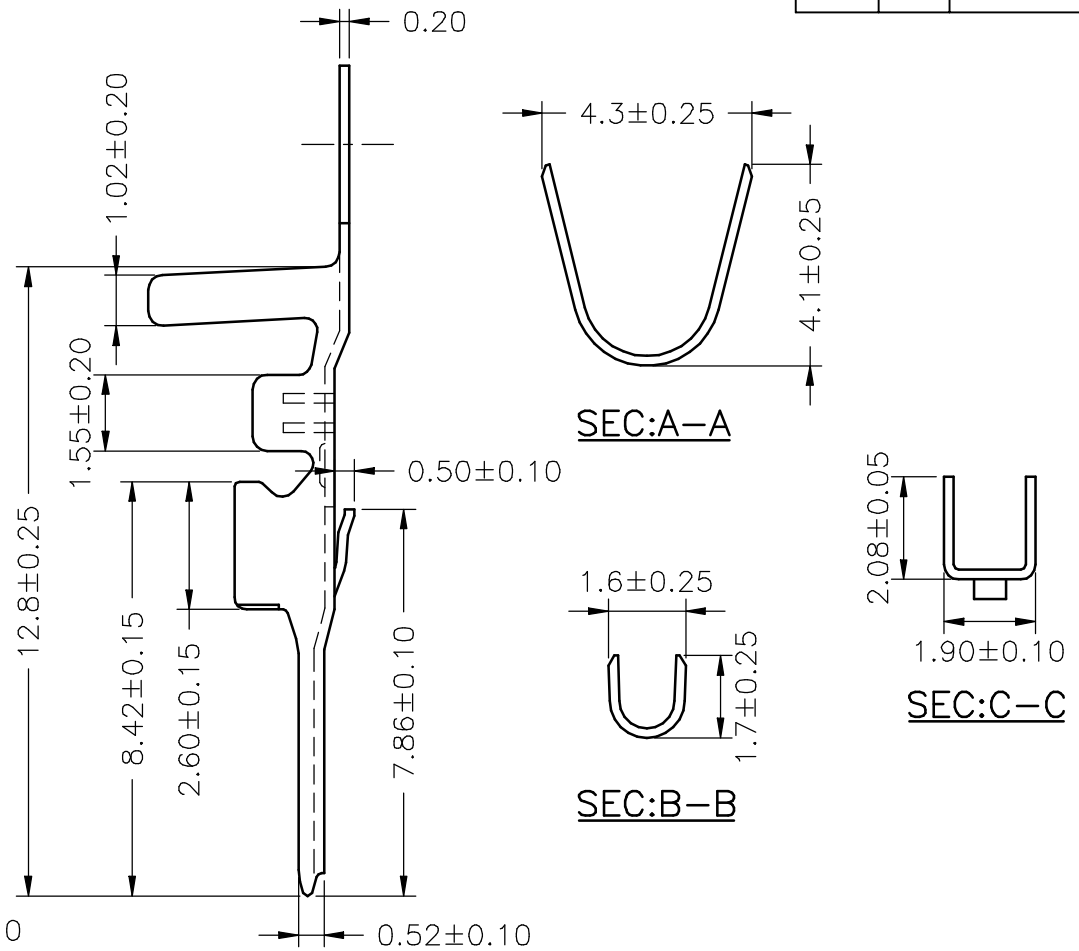
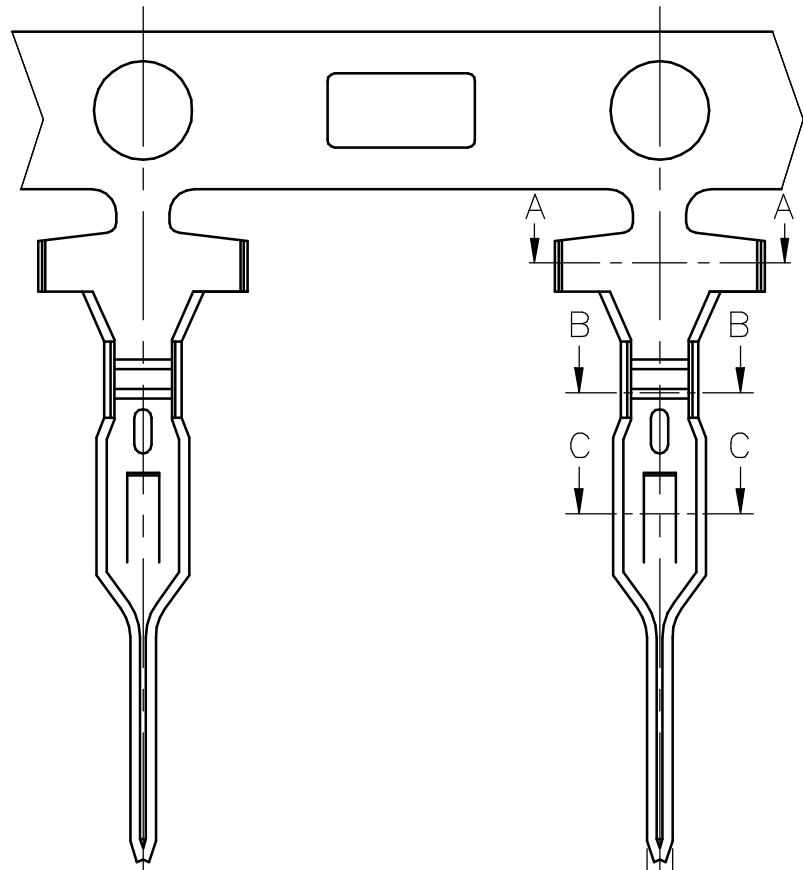

CJT® CHANGJIANG CONNECTORS CO., LTD.
CHANGJIANG CONNECTORS

Ordering information & Specifications

Unit:mm

Part No	Wire Range	Insultion O.D.	Material	Finish	Qty/reel
A4001M-TP	AWG# 22-#28	2.40mm(max)	Phosphor Bronze	Tin-plated	5,000 pcs

Note:e-stamping before Tin-plated

Specification

Client:		Drawing No: A4001M-T	
Tolerance	Draw By: LIZhiQiang	Date: 2008-05-26	Unit:mm Scale:Enone
X. X ≤ 0.25	Checked: HE.	Date: 2008-05-26	
X. XX ≤ 0.15	Approved:	Date:	
X. XXX ≤ 0.10	Material:	Edition: A	

REV	DATE	DESCRIPTION	REVISOR
1.0			

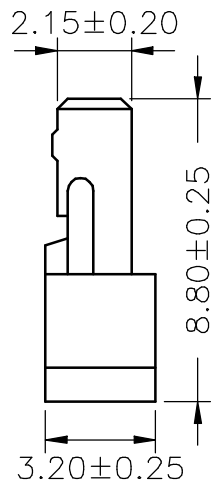
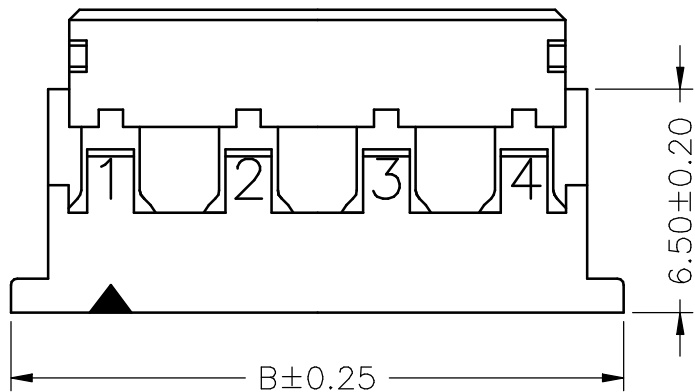
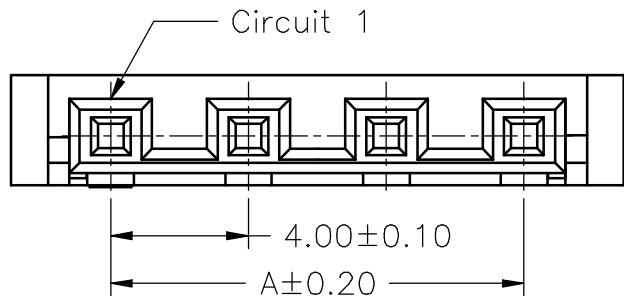
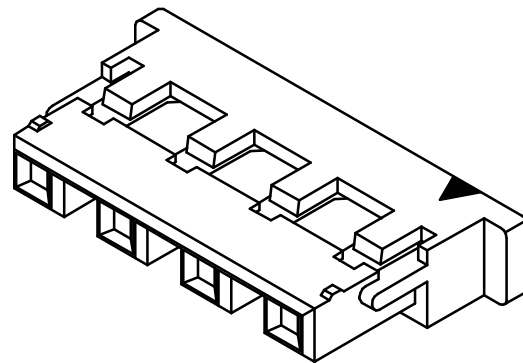

SPECIFICATIONS

Current Rating: 1A AC,DC
Voltage Rating: 600V AC,DC
Temperature Range: $-25^{\circ}\text{C} \sim +85^{\circ}\text{C}$
Contact Resistance: 10mΩ Max
Insulation Resistance: 1000MΩ Min
Withstanding Voltage: 1800V AC/minute
Material: Nylon66,UL94V-0
Color: Natural(White)

Ordering Information & Dimensions

PART NO.	Dimensions	
	A	B
A4001H-2P	4.00	9.80
A4001H-3P	8.00	13.80
A4001H-4P	12.00	17.80
A4001H-5P	16.00	21.80

CJT[®] CHANGJIANG CONNECTORS CO., LTD.
CHANGJIANG CONNECTORS

Specification

Client:		Drawing No: A4001H-NP	
Tolerance	Draw By: LIZhiQiang	Date: 2008-05-26	Unit:mm Scale:Enone
X. X ≤ 0.25	Checked: HE.	Date: 2008-05-26	
X. XX ≤ 0.15	Approved:	Date:	
X. XXX ≤ 0.10	Material:	Edition: A	

REV	DATE	DESCRIPTION	REVISOR
1.0			

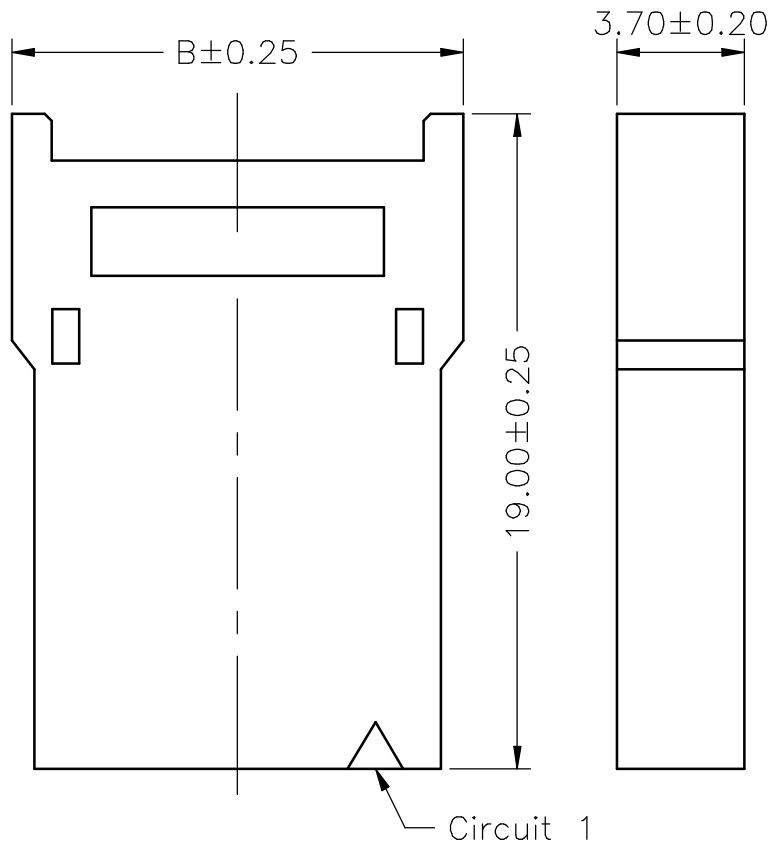
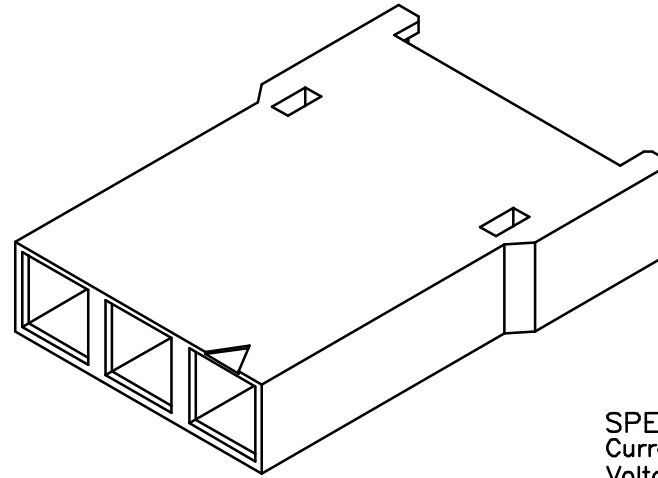
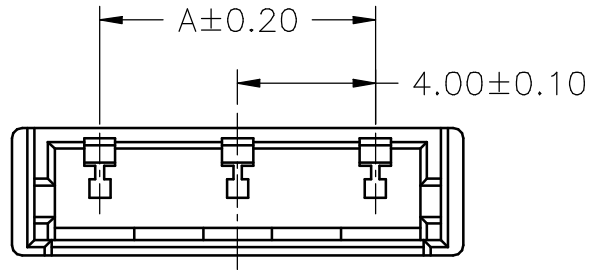

SPECIFICATIONS

Current Rating: 1A AC,DC
 Voltage Rating: 600V AC,DC
 Temperature Range: $-25^{\circ}\text{C} \sim +85^{\circ}\text{C}$
 Contact Resistance: 10m Ω Max
 Insulation Resistance: 1000M Ω Min
 Withstanding Voltage: 1800V AC/minute
 Material: Nylon66,UL94V-0
 Color: Natural(White)

Ordering Information & Dimensions

PART NO.	Dimensions	
	A	B
A4001HM-2P	4.00	9.10
A4001HM-3P	8.00	13.10
A4001HM-4P	12.00	17.10
A4001HM-5P	16.00	21.10



Specification

Client:		Drawing No: A4001HM-NP	
Tolerance	Draw By: LIZhiQiang	Date: 2008-05-26	Unit:mm Scale:Enone
X. $X \leq 0.25$	Checked: HE.	Date: 2008-05-26	
X. $XX \leq 0.15$	Approved:	Date:	
X. $XXX \leq 0.10$	Material:	Edition: A	

REV	DATE	DESCRIPTION	REVISER
1.0			

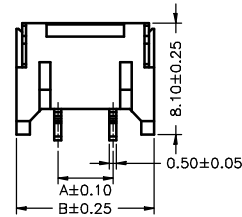
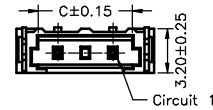
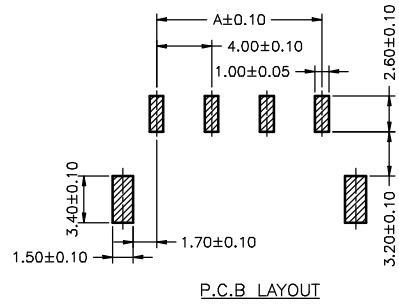

A4001WR-S-2P-1

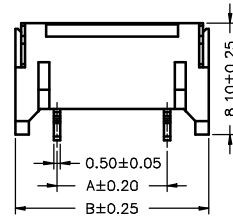
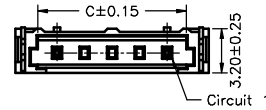

A4001WR-S-2P-2

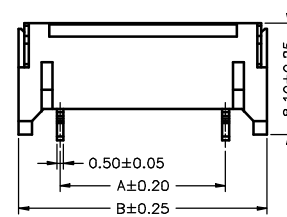
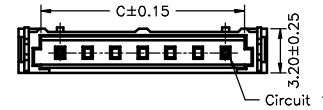

A4001WR-S-2P-3

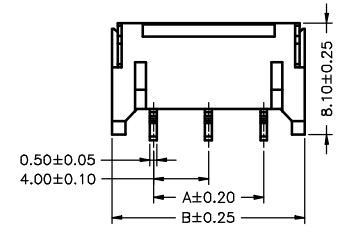
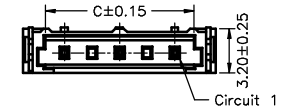

A4001WR-S-3P

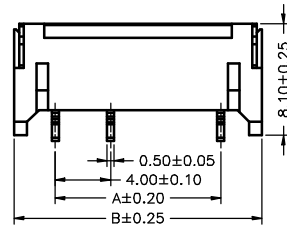
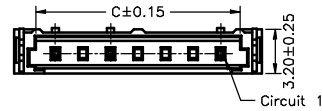
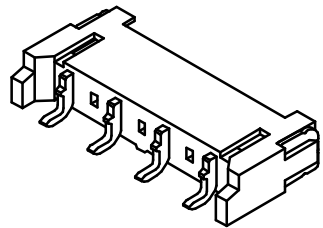
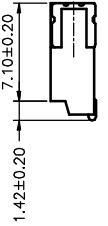

A4001WR-S-4P-137

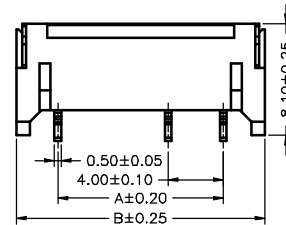
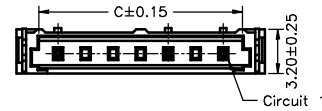

A4001WR-S-4P-157

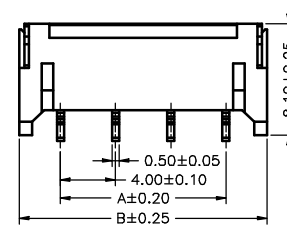
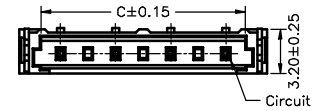

A4001WR-S-4P

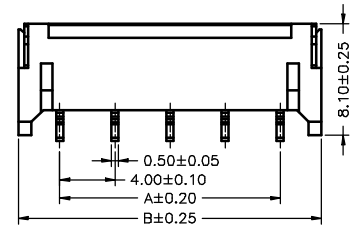
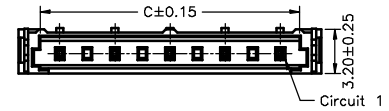

A4001WR-S-5P

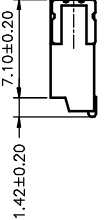

SPECIFICATIONS
 Current Rating: 1A AC,DC
 Voltage Rating: 600V AC,DC
 Temperature Range: -25°C ~ +85°C
 Contact Resistance: 10mΩ Max
 Insulation Resistance: 1000MΩ Min
 Withstanding Voltage: 1800V AC/minute
 Pin Material: Brass/Tin-plated
 Solder Tabs: Brass/Tin-plated
 Material: Nylon 6T,UL94V-0
 Color: Natural(Beige)

Ordering Information & Dimensions

PART NO.	Dimensions		
	A	B	C
A4001WR-S-2P-1	4.00	10.00	6.80
A4001WR-S-2P-2	8.00	14.00	10.80
A4001WR-S-2P-3	12.00	18.00	14.80
A4001WR-S-3P	8.00	14.00	10.80
A4001WR-S-4P-137	12.00	18.00	14.80
A4001WR-S-4P-157	12.00	18.00	14.80
A4001WR-S-4P	12.00	18.00	14.80
A4001WR-S-5P	16.00	22.00	18.80

CJT® CHANGJIANG CONNECTORS CO., LTD.
 CHANGJIANG CONNECTORS

Specification

Client:		Drawing No: A4001WR-S-NP-X	
Tolerance	Draw By: LIZhiQiang	Date: 2008-05-26	Unit:mm Scale:Enone
X.X ≤ 0.25	Checked: HE.	Date: 2008-05-26	
X.XX ≤ 0.15	Approved:	Date:	
X.XXX ≤ 0.10	Material:	Edition: A	

REV	DATE	DESCRIPTION	REVISER
1.0			

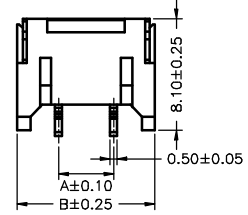
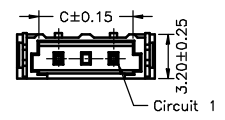
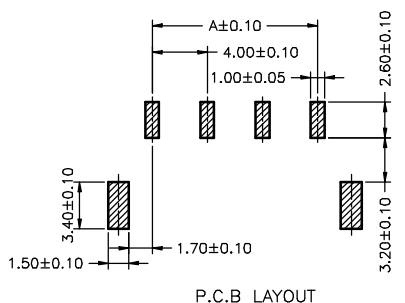

A4001WR-S-2P-1
-GG

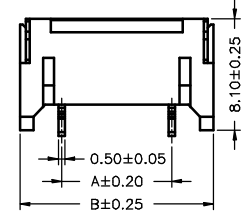
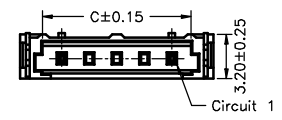

A4001WR-S-2P-2
-GG

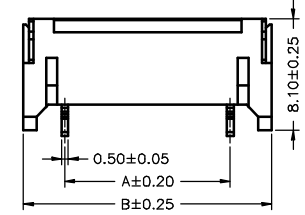
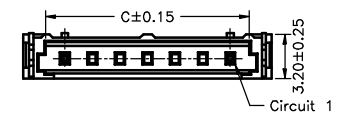

A4001WR-S-2P-3
-GG

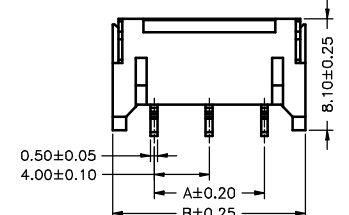
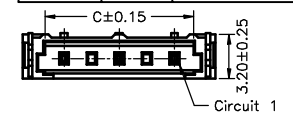

A4001WR-S-3P
-GG

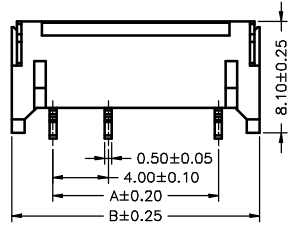
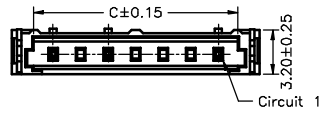
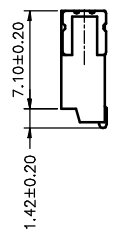

A4001WR-S-4P-137
-GG

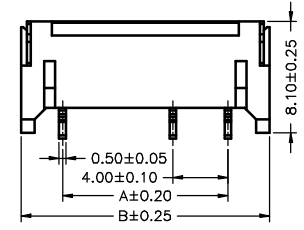
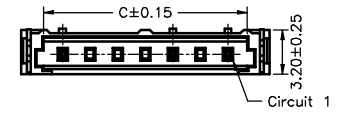

A4001WR-S-4P-157
-GG

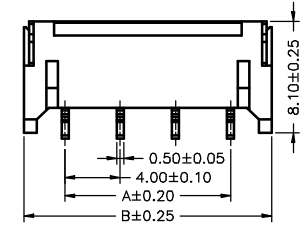
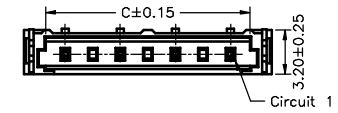

A4001WR-S-4P
-GG

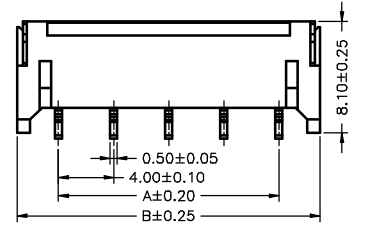
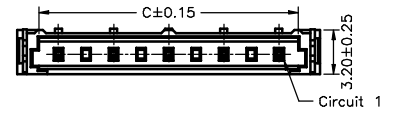

A4001WR-S-5P
-GG

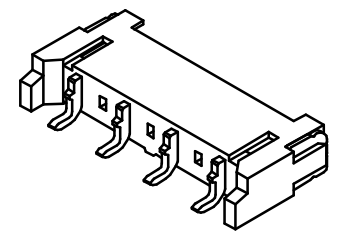
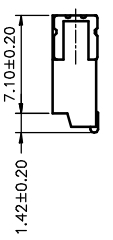

SPECIFICATIONS
 Current Rating: 1A AC,DC
 Voltage Rating: 600V AC,DC
 Temperature Range: -25°C ~ +85°C
 Contact Resistance: 10mΩ Max
 Insulation Resistance: 1000MΩ Min
 Withstanding Voltage: 1800V AC/minute
 Pin Material: Brass/Gold-flash
 Solder Tabs: Brass/Gold-flash
 Material: Nylon 6T,UL94V-0
 Color: Natural(Beige)

Ordering Information & Dimensions

PART NO.	Dimensions		
	A	B	C
A4001WR-S-2P-1-GG	4.00	10.00	6.80
A4001WR-S-2P-2-GG	8.00	14.00	10.80
A4001WR-S-2P-3-GG	12.00	18.00	14.80
A4001WR-S-3P-GG	8.00	14.00	10.80
A4001WR-S-4P-137-GG	12.00	18.00	14.80
A4001WR-S-4P-157-GG	12.00	18.00	14.80
A4001WR-S-4P-GG	12.00	18.00	14.80
A4001WR-S-5P-GG	16.00	22.00	18.80



Specification

Client:		Drawing No: A4001WR-S-NP-X-GG	
Tolerance	Draw By: LIZhiQiang	Date: 2008-05-26	Unit:mm Scale:Enone
X.X ≤ 0.25	Checked: HE.	Date: 2008-05-26	
X.XX ≤ 0.15	Approved:	Date:	
X.XXX ≤ 0.10	Material:	Edition: A	

REV	DATE	DESCRIPTON	REVISER
1.0			

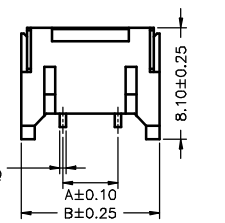
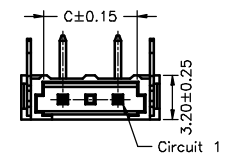
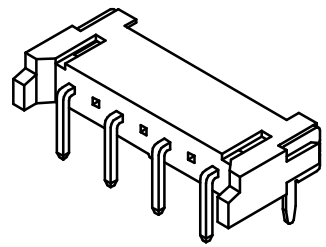
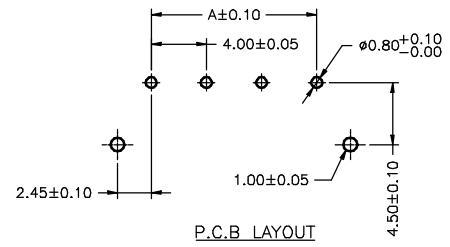

A4001WR-2P-1

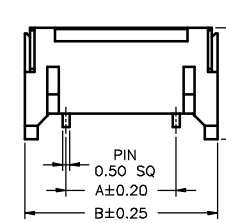
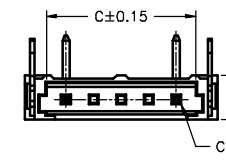

A4001WR-2P-2

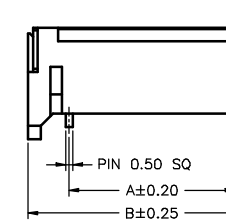
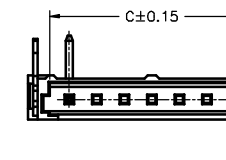

A4001WR-2P-3

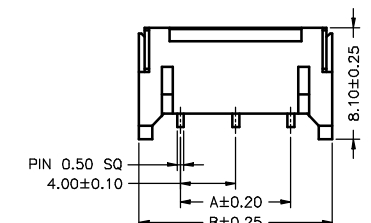
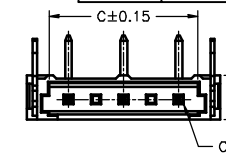

A4001WR-3P

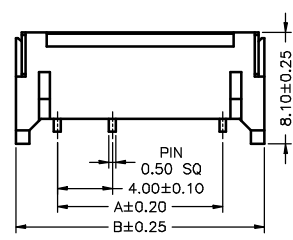
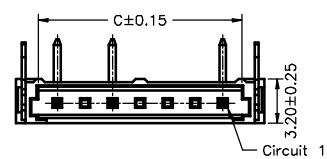
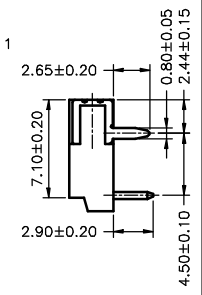

A4001WR-4P-137

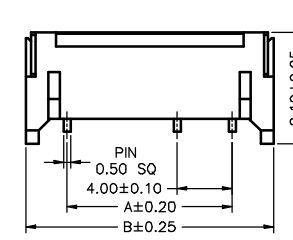
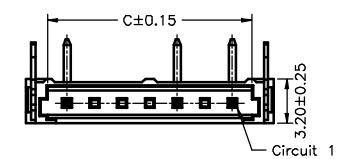

A4001WR-4P-157

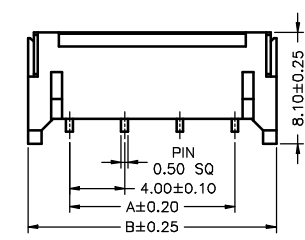
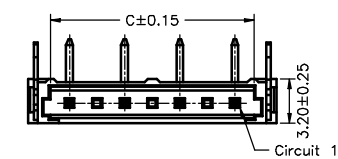

A4001WR-4P

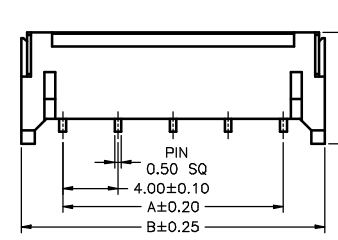
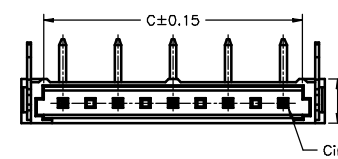

A4001WR-5P

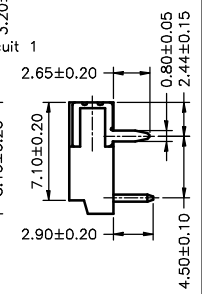

SPECIFICATIONS
 Current Rating: 1A AC,DC
 Voltage Rating: 600V AC,DC
 Temperature Range: -25°C ~ +85°C
 Contact Resistance: 10mΩ Max
 Insulation Resistance: 1000MΩ Min
 Withstanding Voltage: 1800V AC/minute
 Pin Material: Brass/Tin-plated
 Solder Tabs: Brass/Tin-plated
 Material: Nylon 6T,UL94V-0
 Color: Natural(Beige)

Ordering Information & Dimensions:

PART NO.	Dimensions		
	A	B	C
A4001WR-2P-1	4.00	10.00	6.80
A4001WR-2P-2	8.00	14.00	10.80
A4001WR-2P-3	12.00	18.00	14.80
A4001WR-3P	8.00	14.00	10.80
A4001WR-4P-137	12.00	18.00	14.80
A4001WR-5P-157	12.00	18.00	14.80
A4001WR-4P	12.00	18.00	14.80
A4001WR-5P	16.00	22.00	18.80



Specification

Client:		Drawing No: A4001WR-NP	
Tolerance	Draw By: LIZhiQiang	Date: 2008-05-26	Unit:mm Scale:Enone
X.X ≤ 0.25	Checked: HE.	Date: 2008-05-26	
X.XX ≤ 0.15	Approved:	Date:	
X.XXX ≤ 0.10	Material:	Edition: A	