

KBU801G THRU KBU807G(RS801G THRU RS807G)

玻璃钝桥式整流器

GLASS PASSIVATED BRIDGE RECTIFIERS

特征 FEATURES

- Plastic package has Underwriters Laboratory Flammability Classification 94V-0
- High surge current capability
- UL file number: E252843
- High temperature soldering guaranteed: 250°C/10 seconds at 5 lbs.(2.3kg)tension

机械数据 MECHANICAL DATA

CASE: Molded plastic body

Terminals: plated leads solderable per MIL -STD-750, Method 2026

Mounting Position: Any

Mounting Torque: 5in.-lb.max.

Weight: 0.3 ounce, 8.0grams

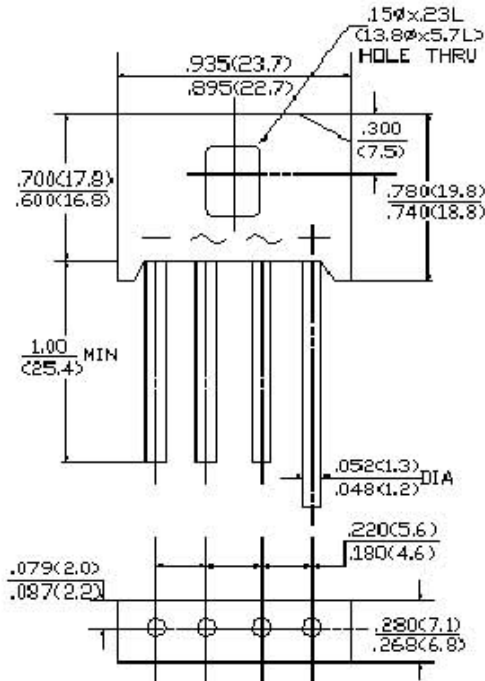

KBU Unit: inch(mm)

极限值和电参数 TA=25°C 除非另有规定

Maximum Ratings & Electrical Characteristics Ratings at 25°C ambient temperature unless otherwise specified

	SYMBOLS	KBU	KBU	KBU	KBU	KBU	KBU	KBU	UNITS
		801G	802G	803G	804G	805G	806G	807G	
		RS	RS	RS	RS	RS	RS	RS	
		801G	802G	803G	804G	805G	806G	807G	
最大可重复峰值反向电压 Maximum repetitive peak reverse voltage	VRRM	50	100	200	400	600	800	1000	Volts
最大均方根电压 Maximum RMS voltage	VRMS	35	70	140	280	420	560	700	Volts
最大直流阻断电压 maximum DC blocking voltage	VDC	50	100	200	400	600	800	1000	Volts
最大正向平均整流电流 @ TA=100°C Maximum average forward output rectified	I(AV)	8							Amps
正向峰值浪涌电流 8.3ms 单一正弦半波 Peak forward surge current 8.3ms single half sine-wave	IFSM	250							Amps
最大正向电压降 Maximum forward voltage @IF=8.0A	VF	1.1							Volts
最大反向漏电流 TA=25°C Maximum reverse voltage TA=125°C	IR	10 500							uA
典型结电容 Type junction capacitance VR=4.0V f=1.0MHZ	CJ	211.0 94							Pf
工作温度和存储温度 Operating junction and storage temperature range	TJ,TSTG	-55 to +150							°C

Rating and Characteristic Curves ($T_A=25^{\circ}\text{C}$ Unless otherwise noted)
KBU801G thru KBU807G RS801G THRU RS801G

Fig. 1 Derating Curve for Output Rectified Current

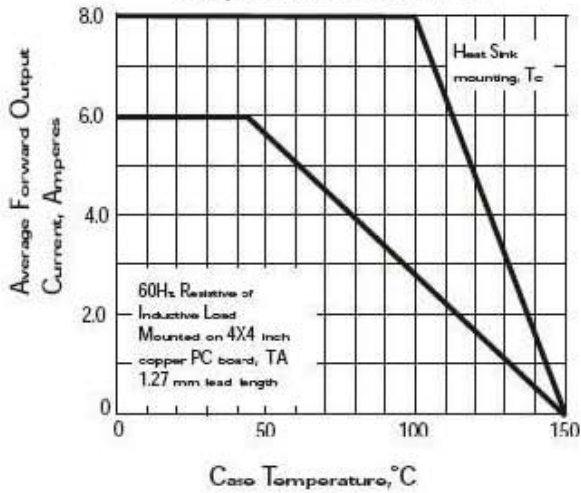

Fig. 2 Maximum Non-repetitive Peak Forward Surge Current

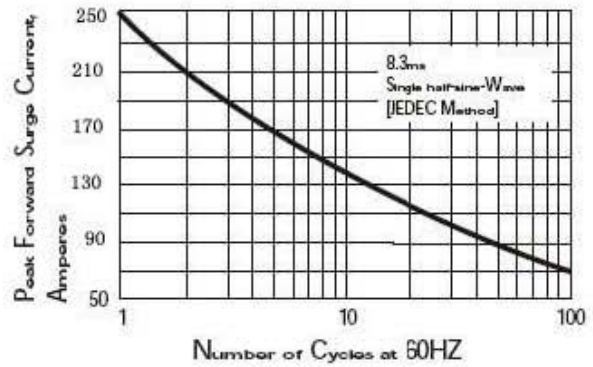

Fig. 3 Typical Instantaneous Forward Characteristics

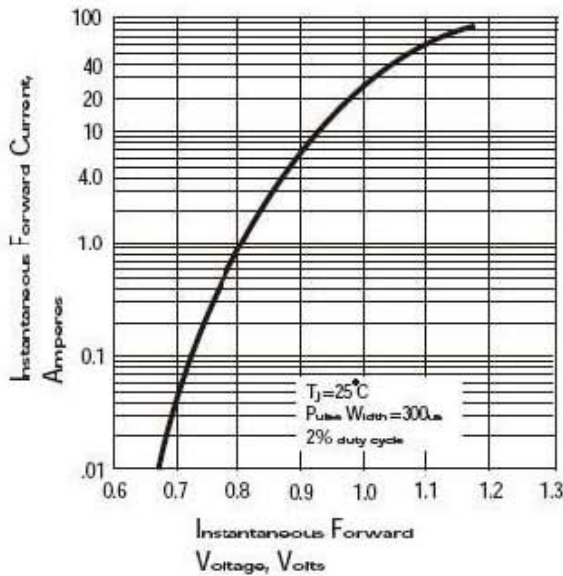

Fig. 4 Typical Reverse Characteristics

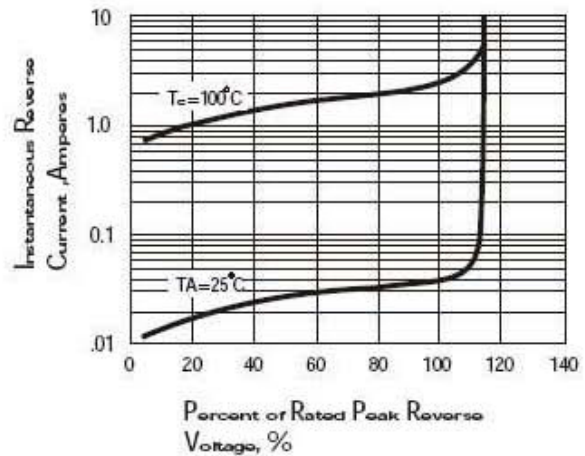

Fig. 5 Typical Junction Capacitance

