



YUEQING Sao Paulo Electronics Co.,Ltd

## SPECIFICATION

STYLE

POWER SWITCH

SIZE

KDC-A04-20-N-C

CUSTOMER

CUSTOMER APPROVED

ADD:NORTH BAIXING ELECTRONICS INDUSTRIAL PARK, YUEQING TOWN, ZHEJIANG

电话: 0577-62881853 传真: 0577-62895077

Guangzhou sales center: Guangzhou city HUIFU road 222, first floor

Tel: 020-83396770 Fax: 020-83262427

P. C.: 520150

Http://www.sple.cn E-mail:sple83195167@163.com

APPROVED	CHECKED	PREPARED

# Sao Paulo Electronics Co,Ltd

## Chief technology request

1. Does not note size tolerance:

0.1-10.0mm±0.10mm

10.0-20.0mm±0.20mm

20.0-50.0mm±0.25mm

2. Appearance

a. Plastic surface should neat, Has not contract hole, Fly side,  
Is short of material, Waits for defection.

b. Metal a surface electroplate good, Bright has not fall off,  
Has not rust wait for phenomenon.

3. Inserts piece of have not distortion, Cooperates with not become less crowded

4. Handspike action agility, Feel good.

5. The main technique parameters

Use temperature scope: -20-85°C

Rated load: 5A/80A 250V AC

Contact resistance:  $\leq 50m\Omega$

Insulation resistance:  $\geq 100m\Omega$

Endurance: AC 1500V(e-e), AC3500V(e-and)

Insertion force:  $5\pm 3N$

life: 10000times

## Raw material ingredient requests

No.	DESCRIPTION	QTY	MATERIAL	PLATING
1	Move touch piece of	2	FE-Y2-0.4	D.CT
2	Quiet touch piece of	2	H62-Y2-1	D.CT
3	Embed	2	Fe-Y2-0.4	D.CT
4	Outer shell	1	bakelite (black)	
5	Handspike	1	PBT white	
6	Bracket	2	H62-Y2-1	D.CT
7	Goes to hook	1	1Cr18NiTi- $\phi$ 0.8	
8	Replaces spring	1	Carbon spring steel wire $\phi$ 0.5	D.Zn15.DC
9	V type reed	2	QBe2-CY-0.25	
10	Blind flange	1	08F-0.8	
11	Crosspiece board	1	08F-0.6	D.Zn15.DC
12	Electroform touch point of (Movement)	2	Cu	
13	Electroform touch point of (Quiet)	2	Cu	

# Sao Paulo Electronics Co Ltd

MAIN SPECIFICATIONS			
TYPE OF SWITCH		MODEL NO	
1) CONSTRUCTION			
1-1 SHAPE AND DIMENIONS SUBJECT TO ATTACHED CHART REGULATION			
1-2 APPEARANCE EVRY PART SHOULD BE FINISHED NOT TO EXIST RUST. FLAW CRACK AND BAD PLATING.			
2) ELECTRICAL STRUCTURE			
2-1 PATING NON AC250V 2A/4A/5A/8A			
2-2 CONTACTRESISTANCE 0.05Ω MAX			
2-3 INSULATIONRESISTANCE MORE THANDC≥100MΩ MIN			
2-4 VOLTAGE WITHSTANDING:1500v, AC/minute			
2-5 TEMPERATURE -25℃ ~ -85℃			
2-6 SOLDERABILITY			
WELDING TEMPERATURE	235℃±5℃		
DIPPING TIME	2S±0.5S		
3) MECHANICAL STRUCTURE			
3-1 LIFE 10, 000TIMES			
3-2 Action Force:3 ~ 8N			

:

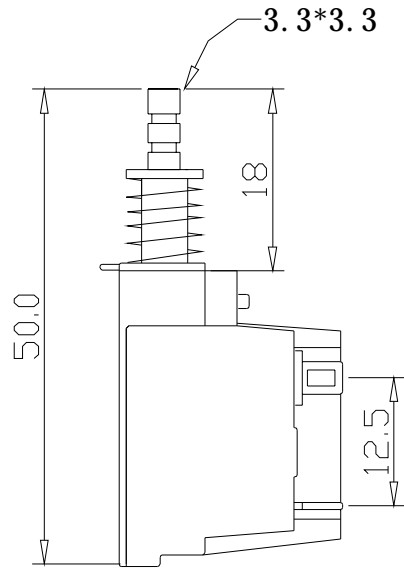
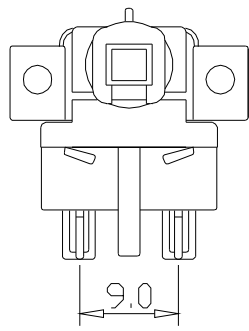

2-0.5\*

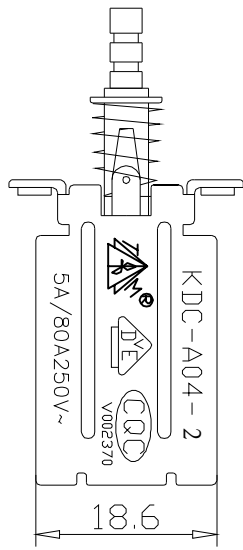

电 路 图

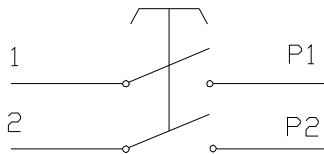

镀涂

旧底图总号

更改标记	数量	更改单号	签 名	日期
------	----	------	-----	----

KDC-A04-20-N-C

SBL 7.740.019

底图总号

设计	核
审	工
核	艺

等 级 标 记 | 重 量 | 比 例

日 期 | 签 名

ALE
标 准 化
批 准

第 张 共 张

乐清市圣保罗电子有限公司

格式(1)

制图

描图

幅面: 4