



安能电源连接器 Anen power Connectors

纳百川料号 (NBC Code): PA45

物料名称 (Name of Material): 安能 45A 单极电源连接器

版次: A

拟制 (Drafted By): Mark_Lee

审核 (Reviewed By): Lzy

批准 (Approved By): Ldg

发行日期: 2008 年



一. 物料名称 (Name of Material): 45A 安能单极电源连接器 Anen Power Series 45 Connectors (Single -Pole)

二. 规格型号 (Type) : PA45

三. 技术参数 (Technical Parameters)

1. 产品特性要求 (Product Specifications)

额定电流 (Rated Current): 45A

额定电压 (Rated Voltage): 600V

绝缘电阻 (Insulation resistance): 500MΩ

产品接触电阻 (contact resistance) : 0.060 ± 0.005mΩ (毫欧)

耐电压 (Voltage Proof): 2200V (DC)

使用线径 (Contact Barrel Wire Size): 10-14AWG (5.3-2.1mm²)

机械寿命 (Mechanical Life): ≥ 5000 次

胶壳防火等级 (Flammability Rating of Housing Material): UL94 V-0

产品插拔力 (Avg. Connection/Disconnect)

A. 成品插入力 (The insertion force of finished products): ≥ 0.5 kgf

B. 成品拔出力 (The pullout force of finished products): ≥ 0.4 kgf

C. 线材与端子拉拔力: 参考同规格 UL 标准; The Pulling capacity between wire and terminal , It's in line with UL standard:

2. 材料及表面处理 (Material and Surface Performance)

A. 端子 (Contacts):

材料 (Material): 紫铜 (Red Copper)

生产工艺 (Process of Production): 精密冲压 (Precision Punching)

表面处理: 镀亮锡, 厚度 25 μm (shiny tin-plating with thickness 25 μm on surface)

胶壳 (Housing)

材料 (Material): PC2320 / PC2320

颜色 (Colour): 红. 黄. 绿. 蓝. 灰. 白. 黑; (Red, Yellow, Green, Blue, Gray, White, Black)

生产工艺 (Process of Production): 注塑成型 (Plastic Injection)

四. 最大外型尺寸 (Most figure size) : 8*8*24.6

五. 物料简介 (Brief Introduction of Material)

1. 基本情况 (Basic Condition)

A. 此系列 Anen 安能连接器主要适合电源部分. 大电流和高电压接触场合使用; (Anen connector series mostly is suitable for electrical source mains, high current and high voltage usage)

B. 接触迅速, 插拔时杂波少; (rapid contact, low noise caused by mating)

C. 可单独使用, 也可任意拼装, 拼装后中心距 7.9mm; (It can be used independently, or in group combination, The center distance is 7.9mm after combined)

D. 也可配套固定座方式组装, 我司可提供 4 位. 6 位固定座加以固定; (fixture available, Our company can provide 4-6-way fixture for holding the connectors)

E. 产品 UL 认证号码: E319259; (File No. E319259 of UL)

F. 产品适用行业 Applicable products industry

(1). 物料输送设备/电动车辆 MATERIAL HANDLING / ELECTRIC VEHICLES

(2). 电信设备. 仪器 TELECOMMUNICATIONS



- (3). UPS 系统 UPS SYSTEMS
- (4). 个人移动市场(移动产品) PERSONAL MOBILITY MARKET
- (5). 医疗设备 MEDICAL
- (6). 组合式办公设备 MODULAR OFFICE EQUIPMENT
- (7). AC/DC 电源设备 AC/DC POWER MANAGEMENT

2. 包装储存 (Packing and Storage)

A. 胶壳最少包装 500PCS/袋; 端子最少包装 2000PCS/卷, 配用方式: 一对一; (standard packing qty: 500PCS/bag for connector, 2000PCS/reel for terminal; Mate with way : (1 connector uses 1 terminal) or one to one

B. 产品储存环境温度: 5-30℃, 相对湿度在: 80%以下, 周围空气中无酸. 碱等腐蚀气体的仓库中, 储存期为: 两年(从生产日期算起); (The products storage condition: temperature: 5-30℃, relative humidity: 80%, store in no acidic nor alkaline and no corrosive atmosphere warehouse, storage period: 2years (from production date)

六. 产品料号对照表 Ordering Information

A. 胶壳料号 Housings Only

胶壳颜色 Housing Color	料号 Part Number
红 Red Housing	PA45B2-H
黄 Yellow Housing	PA45B4-H
绿 Green Housing	PA45B5-H
蓝 Blue Housing	PA45B6-H
灰 Gray Housing	PA45B8-H
白 White Housing	PA45B9-H
黑 Black Housing	PA45B0-H

B. 端子料号 Contacts

料号 Part Number	线径 Wire OD
PA261G2-T	10/14 (AWG) 5. 3/2. 1 (sq. mm)

C. 整套产品料号 (Housing& 45Amp Contact)

胶壳颜色 Housing Color	料号 Part Number
红 Red Housing	PA45-2
黄 Yellow Housing	PA45-4
绿 Green Housing	PA45-5
蓝 Blue Housing	PA45-6
灰 Gray Housing	PA45-8
白 White Housing	PA45-9
黑 Black Housing	PA45-0



七. 产品图形及组装方式示意图 (product drawing and combination illustration)

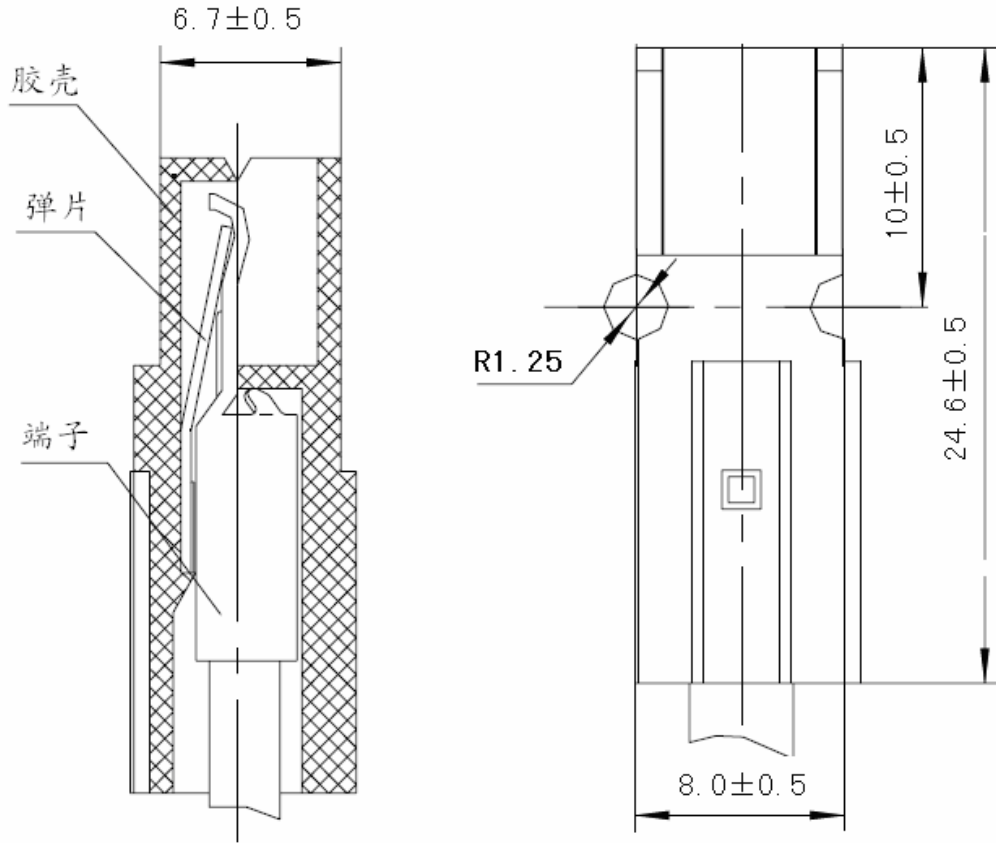

成品组装图+胶壳主要尺寸

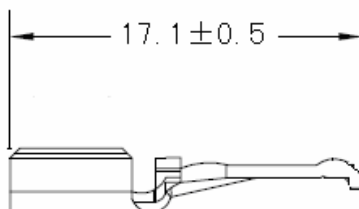
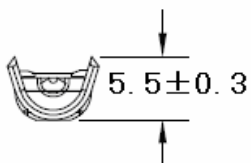
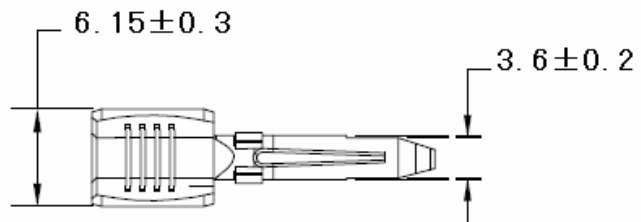
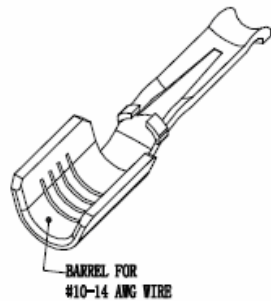
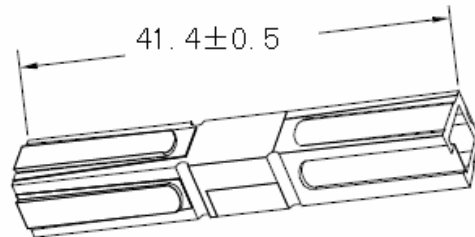

五金端子主要尺寸



CAT. NO. : PA1470G1

4 POLE RECEPTACLE EXPLODED VIEW

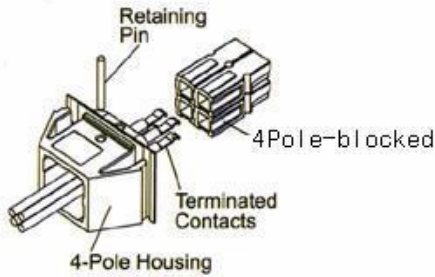

CAT. NO. : PA1460G1

4 POLE PLUG EXPLODED VIEW WITH CABLE CLAMP

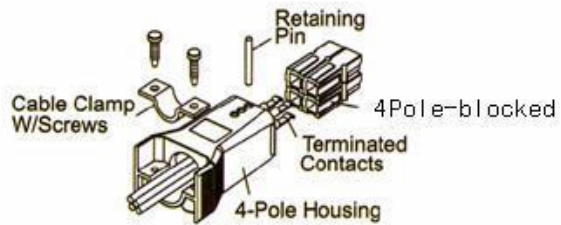

CAT. NO. : PA1470G3

4 POLE PLUG EXPLODED VIEW WITH CABLE CLAMP

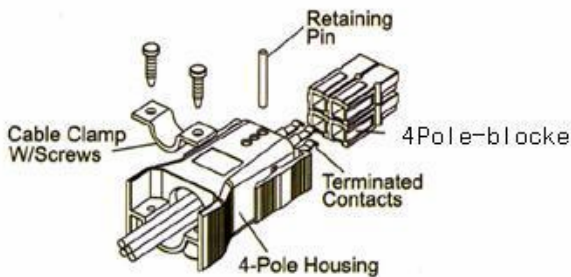

CAT. NO. : PA1470G2

6 POLE RECEPTACLE EXPLODED VIEW

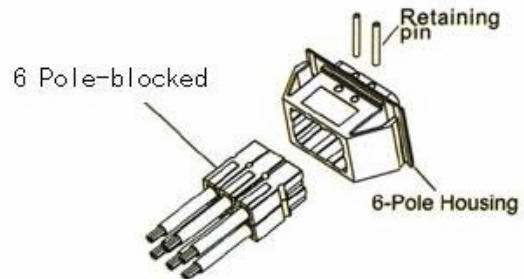

CAT. NO. : PA1470G4

6 POLE PLUG EXPLODED VIEW WITH CABLE CLAMP

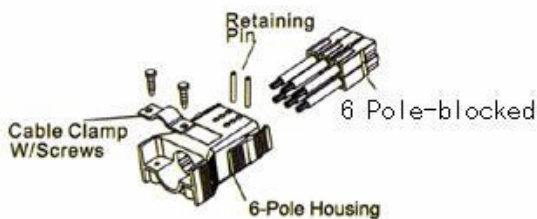

CAT. NO. : PA1460G2

6 POLE PLUG EXPLODED VIEW WITH CABLE CLAMP

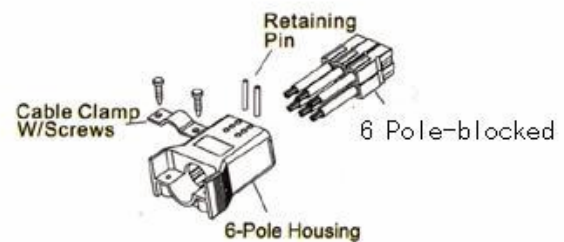

电源连接器应用