

THIS DRAWING IS UNPUBLISHED. RELEASED FOR PUBLICATION
 © COPYRIGHT - By - ALL RIGHTS RESERVED.

| LOC | | DIST | | REVISIONS | | | |
|-----|-----|-------------|----------|---------------|---------|------|-----|
| P | LTR | DESCRIPTION | | DATE | DWN | APVD | |
| ES | 00 | E7 | RELEASED | ECR-11-021722 | 21SEP11 | J.J | S.Y |

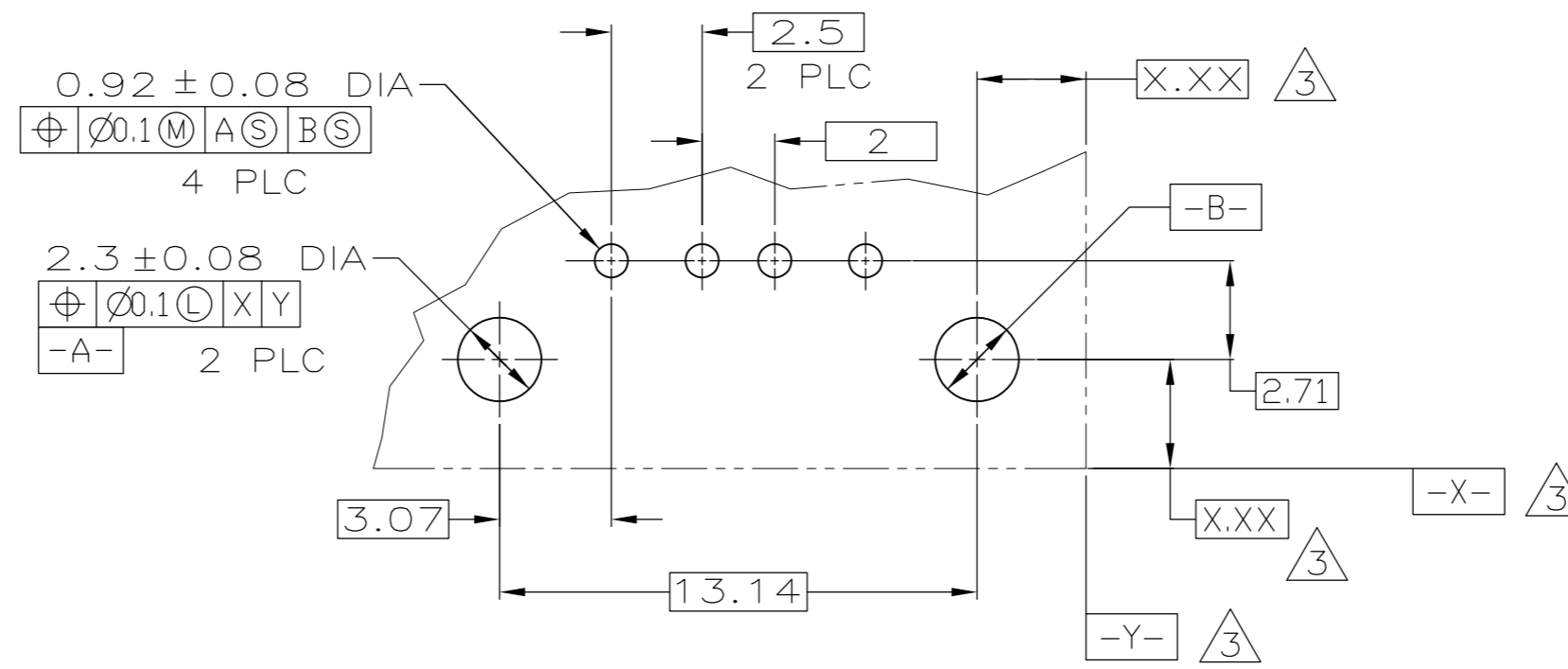
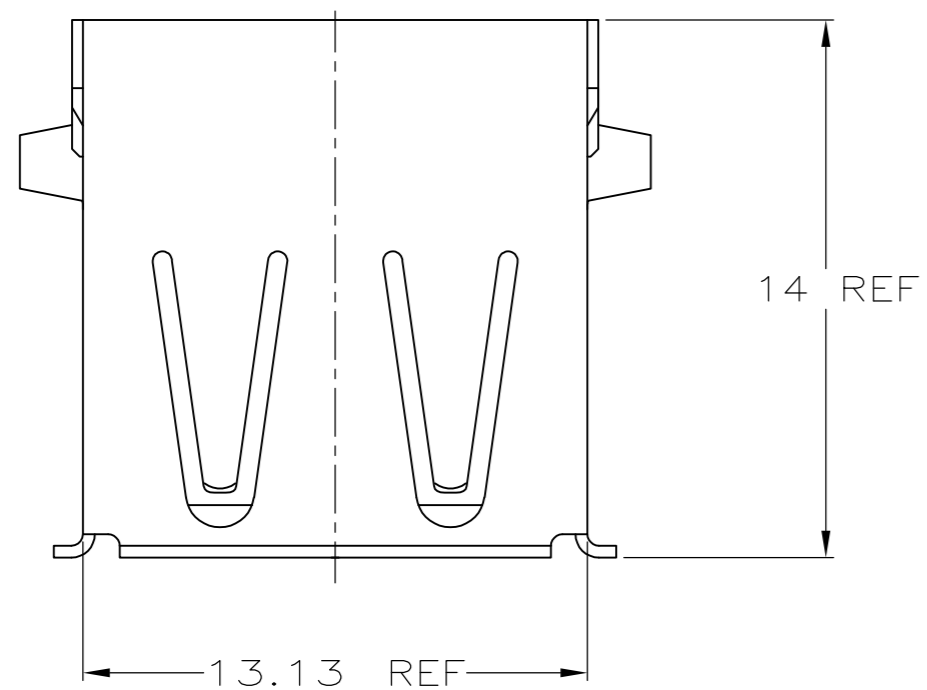

PC BOARD MOUNTING DIMENSIONS ④

- ① MATERIAL:
 SHELL & CONTACTS- COPPER ALLOY.
 HOUSING: UL 94V-0 RATED, THERMOPLASTIC, COLOR SEE TABLE.
- ② PLATING:
 CONTACTS: 0.076 μm MINIMUM GOLD OVER 0.76 PALLADIUM-NICKEL ON MATING AREA.
 3.8 μm MINIMUM MATTE TIN ON SOLDER TAILS.
 BOTH OVER 1.27 μm MINIMUM NICKEL.
 CONTACT ALTERNATE PLATING: 0.76 μm MINIMUM AREA, 3.80 μm MIN MATTE TIN ON SOLDER TAILS, BOTH OVER 1.27 μm MIN NICKEL.
 SHELL: 2~5 μm MINIMUM BRIGHT TIN
- ③ DATUM AND BASIC DIMENSIONS ESTABLISHED BY CUSTOMER.
- ④ RECOMMENDED PC BOARD THICKNESS OF 1.57.

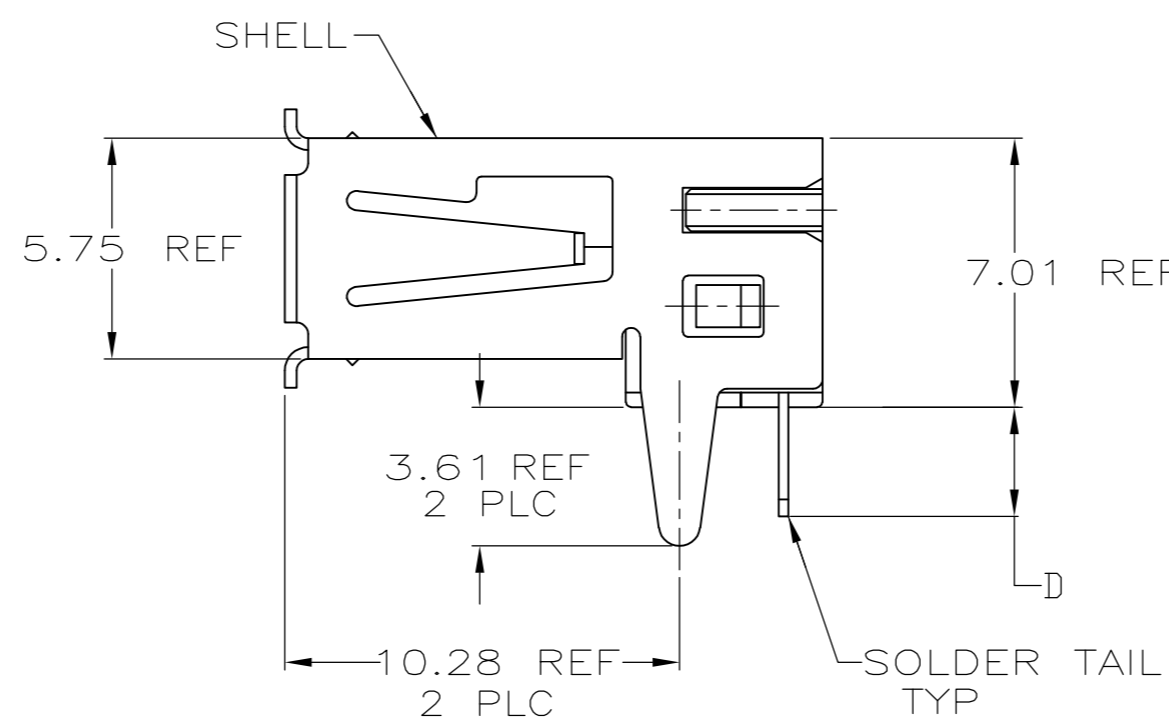
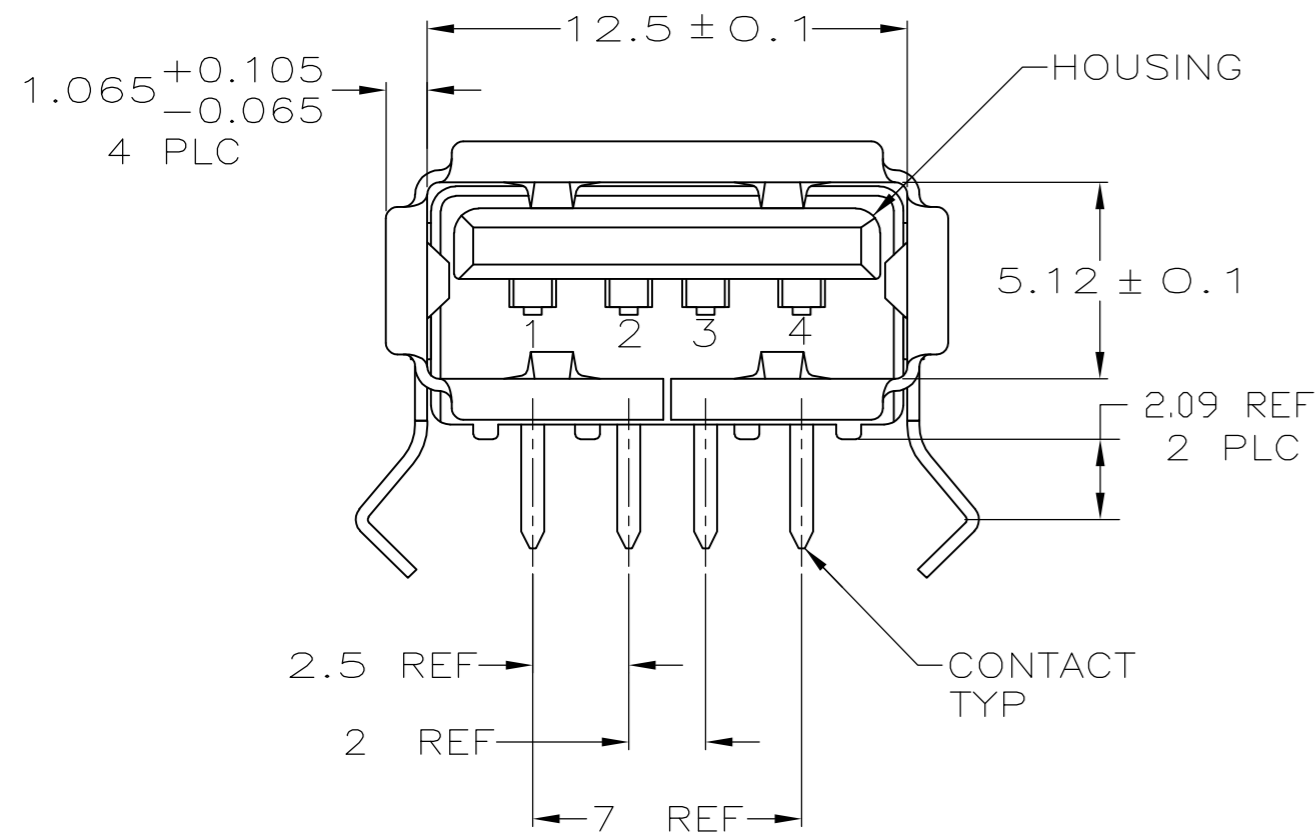

| | | | |
|-----------------------------|------|---------------|-------------|
| NO | 3.81 | BLACK | 1-292303-5 |
| NO | 3.56 | BLACK | 1-292303-4 |
| NO | 3.20 | BLACK | 1-292303-3 |
| YES | 3.30 | BLACK | 1-292303-2 |
| YES | 2.29 | BLACK | 292303-6 |
| YES | 2.84 | NATURAL | 292303-5 |
| YES | 2.84 | BLACK | 292303-4 |
| NO | 2.84 | NATURAL | 292303-3 |
| NO | 2.29 | BLACK | 292303-2 |
| NO | 2.84 | BLACK | 292303-1 |
| HIGH TEMPERATURE COMPATIBLE | D | HOUSING COLOR | PART NUMBER |

| | | | | |
|--|---|-----------------------------|------------------------------|---------------|
| THIS DRAWING IS A CONTROLLED DOCUMENT. | | DWN J.JIANG 19FEB04 | | |
| DIMENSIONS: mm | | CHK S.YAO 19FEB04 | | |
| TOLERANCES UNLESS OTHERWISE SPECIFIED: | | APVD T.SASAKI 19FEB04 | NAME | |
| 0 PLC ± - | | PRODUCT SPEC | RECEPTACLE ASSEMBLY RIGHT | |
| 1 PLC ± - | | APPLICATION SPEC | ANGLE, 4 POSITION, T/H & SMT | |
| 2 PLC ± 0.25 | | 108-60034 | USB, LEAD FREE VERSION | |
| 3 PLC ± - | | | SIZE | CAGE CODE |
| 4 PLC ± - | | | A2 | 00779 |
| ANGLES ± - | | | DRAWING NO | RESTRICTED TO |
| FINISH | | WEIGHT | C=292303 | - |
| ① | ② | CUSTOMER DRAWING | SCALE 5:1 | SHEET 1 of 4 |
| | | | REV E7 | |

| LOC | | DIST | | REVISIONS | | | |
|-----|-----|-------------|------|-------------|------|---|---|
| P | LTR | DESCRIPTION | DATE | DWN | APVD | | |
| ES | 00 | - | - | SEE SHEET 1 | - | - | - |

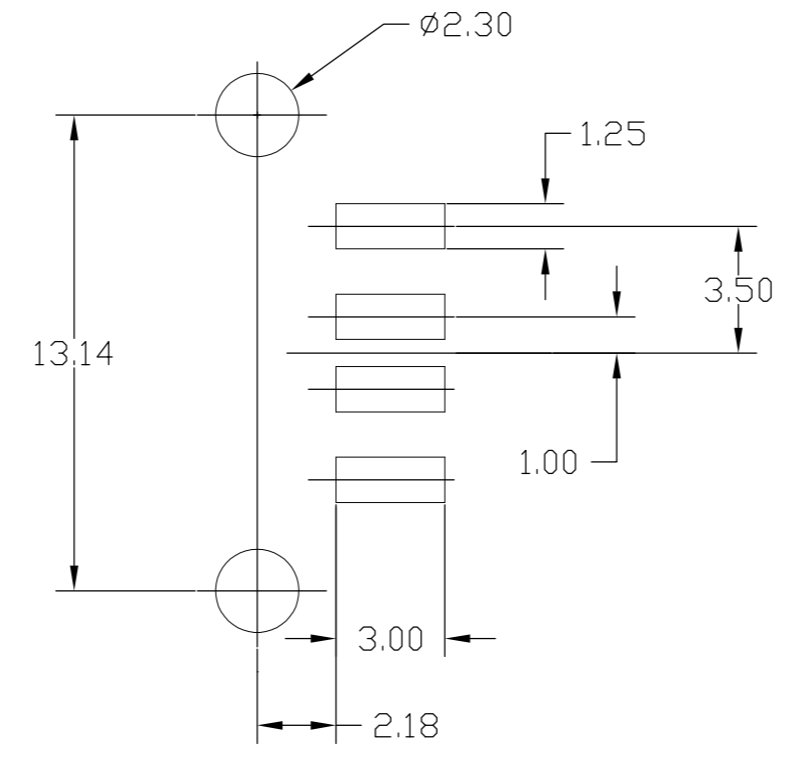
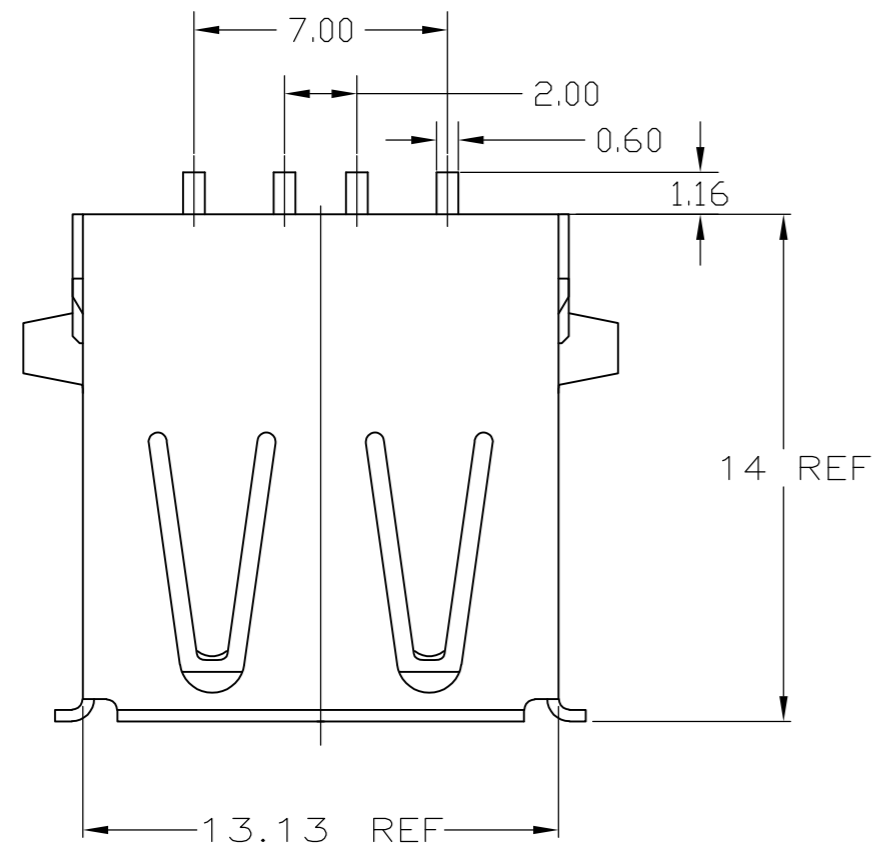

- ⚠ MATERIAL:
SHELL & CONTACTS- COPPER ALLOY.
HOUSING: UL 94V-0 RATED, THERMOPLASTIC, COLOR SEE TABLE.
- ⚠ PLATING:
CONTACTS: 0.076 μm MINIMUM GOLD OVER 0.76 μm MINIMUM PALLADIUM-NICKEL ON MATING AREA.
3.8 μm MINIMUM MATTE TIN ON SOLDER TAILS.
BOTH OVER 1.27 μm MINIMUM NICKEL.
CONTACT ALTERNATE PLATING: 0.76μm MIN GOLD ON MATING AREA, 3.80 μm MIN MATTE TIN ON SOLDER TAILS, BOTH OVER 1.27 μm MIN NICKEL.
SHELL: 2~5 μm MINIMUM BRIGHT TIN
- ⚠ RECOMMENDED PC BOARD THICKNESS OF 1.42.

RECOMMENDED PC BOARD MOUNTING LAYOUT ⚠
 (TOLERANCE=±0.05)

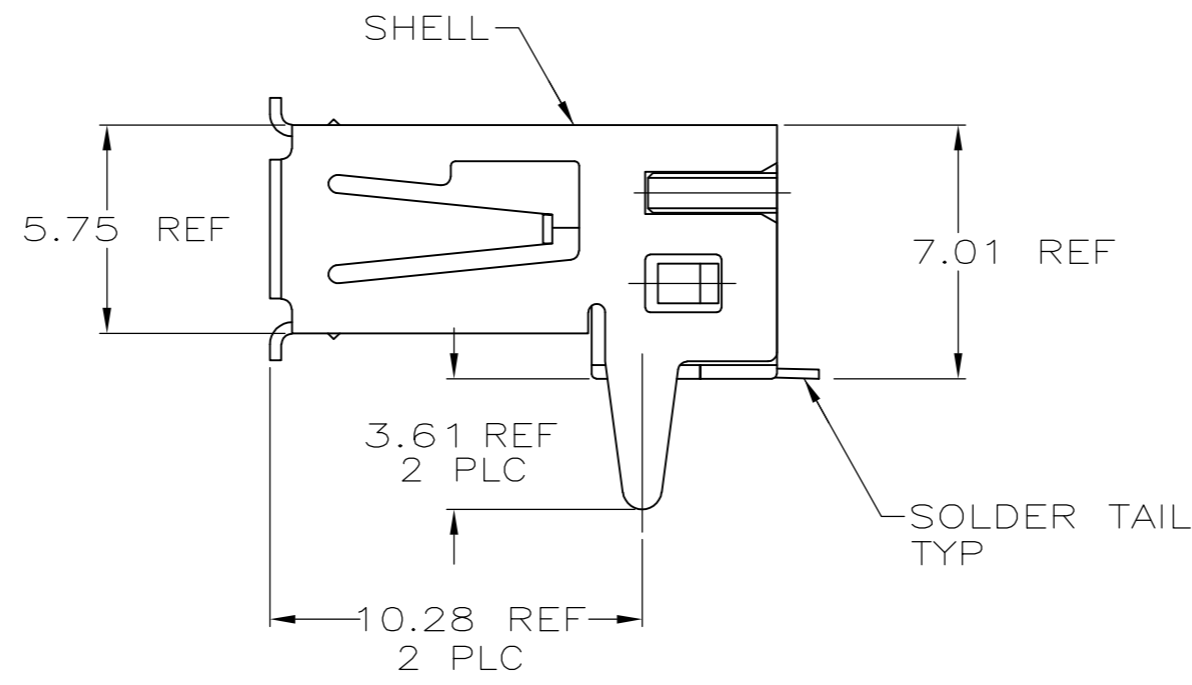
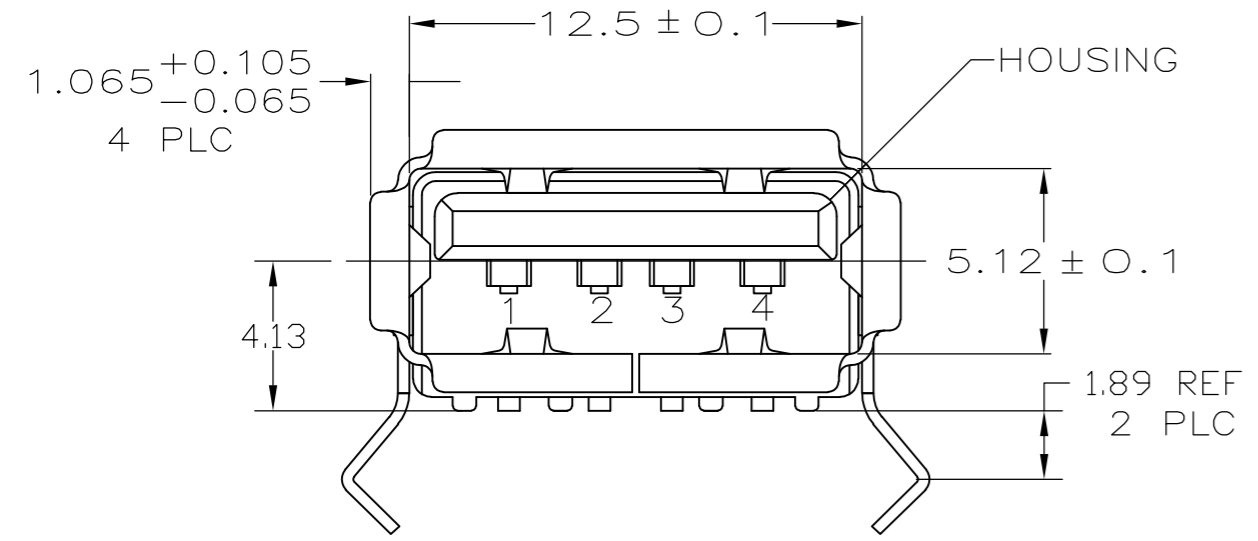

| | | |
|-----------------------------|---------------|-------------|
| YES | BLACK | 1-292303-1 |
| YES | NATURAL | 292303-7 |
| HIGH TEMPERATURE COMPATIBLE | HOUSING COLOR | PART NUMBER |

| | | | | | | | | | | | | | | | | | | |
|---|---------------|-----------------------------|---|------------------|-----|-------------------------------|--------|-------|-----|-------|-----|--------|-----|---------------------------|------------|--------------------|------------------------|--------------------|
| THIS DRAWING IS A CONTROLLED DOCUMENT. | | DWN J.JIANG 19FEB04 | TE Connectivity | | | | | | | | | | | | | | | |
| DIMENSIONS: mm | | CHK S.YAO 19FEB04 | | | | | | | | | | | | | | | | |
| TOLERANCES UNLESS OTHERWISE SPECIFIED: | | APVD T.SASAKI 19FEB04 | NAME RECEPTACLE ASSEMBLY RIGHT ANGLE, 4 POSITION, T/H & SMT USB, LEAD FREE VERSION | | | | | | | | | | | | | | | |
| <table border="1"> <tr><td>0 PLC</td><td>± -</td></tr> <tr><td>1 PLC</td><td>± -</td></tr> <tr><td>2 PLC</td><td>± 0.25</td></tr> <tr><td>3 PLC</td><td>± -</td></tr> <tr><td>4 PLC</td><td>± -</td></tr> <tr><td>ANGLES</td><td>± -</td></tr> </table> | | 0 PLC | ± - | 1 PLC | ± - | 2 PLC | ± 0.25 | 3 PLC | ± - | 4 PLC | ± - | ANGLES | ± - | PRODUCT SPEC 108-60034 | SIZE A2 | CAGE CODE 00779 | DRAWING NO C-292303 | RESTRICTED TO - |
| 0 PLC | ± - | | | | | | | | | | | | | | | | | |
| 1 PLC | ± - | | | | | | | | | | | | | | | | | |
| 2 PLC | ± 0.25 | | | | | | | | | | | | | | | | | |
| 3 PLC | ± - | | | | | | | | | | | | | | | | | |
| 4 PLC | ± - | | | | | | | | | | | | | | | | | |
| ANGLES | ± - | | | | | | | | | | | | | | | | | |
| MATERIAL ⚠ 1 | FINISH ⚠ 2 | APPLICATION SPEC - | WEIGHT - | CUSTOMER DRAWING | | SCALE 5:1 SHEET 2 of 4 REV E7 | | | | | | | | | | | | |

| LOC | DIST | REVISIONS | | | |
|-----|------|-------------|------|-----|------|
| P | LTR | DESCRIPTION | DATE | DWN | APVD |
| ES | 00 | SEE SHEET 1 | - | - | - |

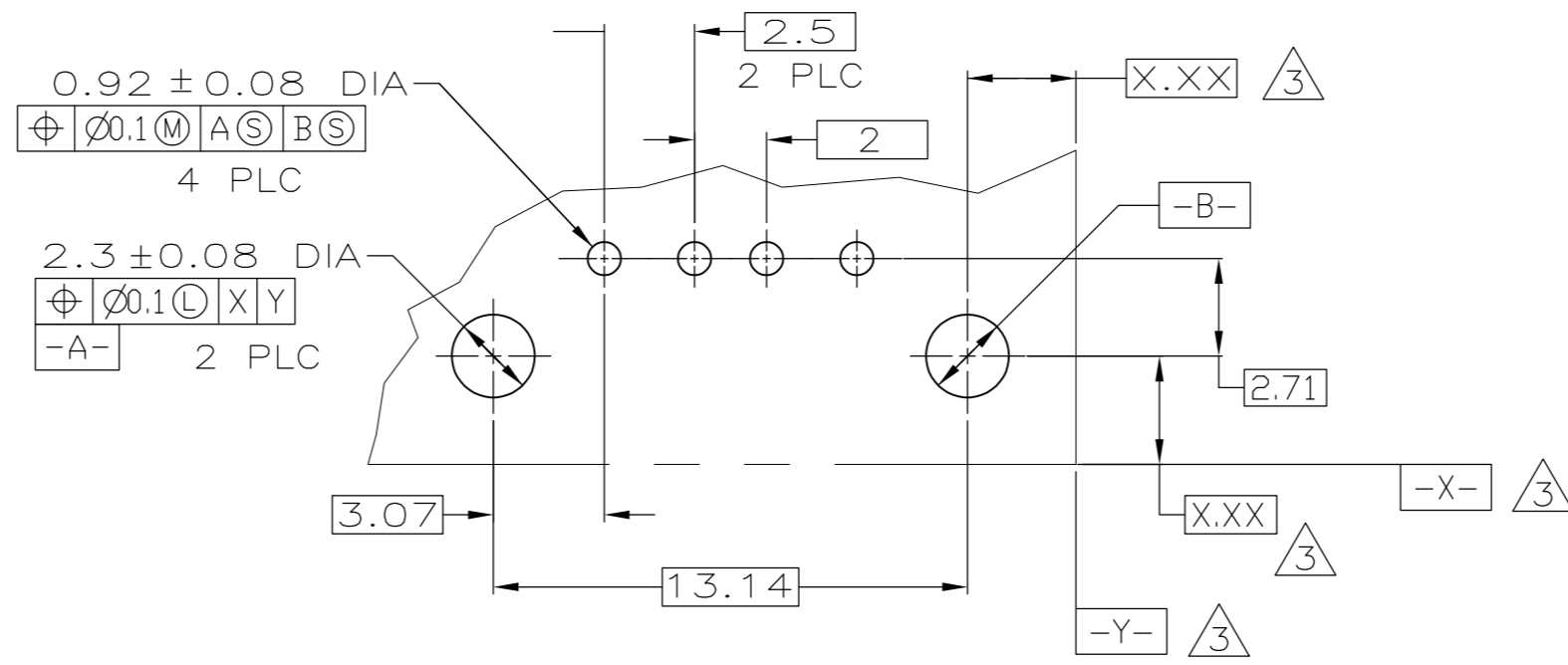
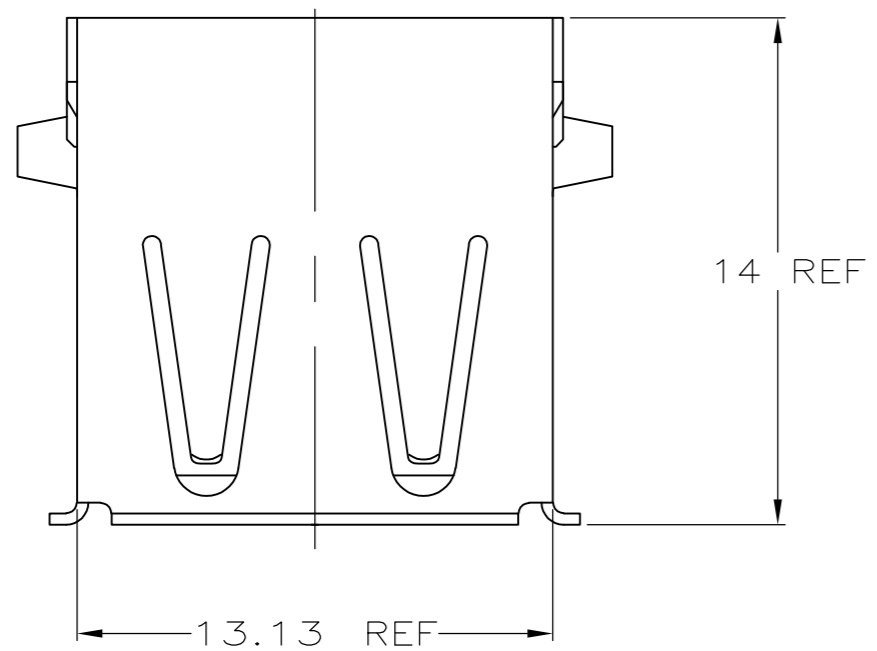

PC BOARD MOUNTING DIMENSIONS 4

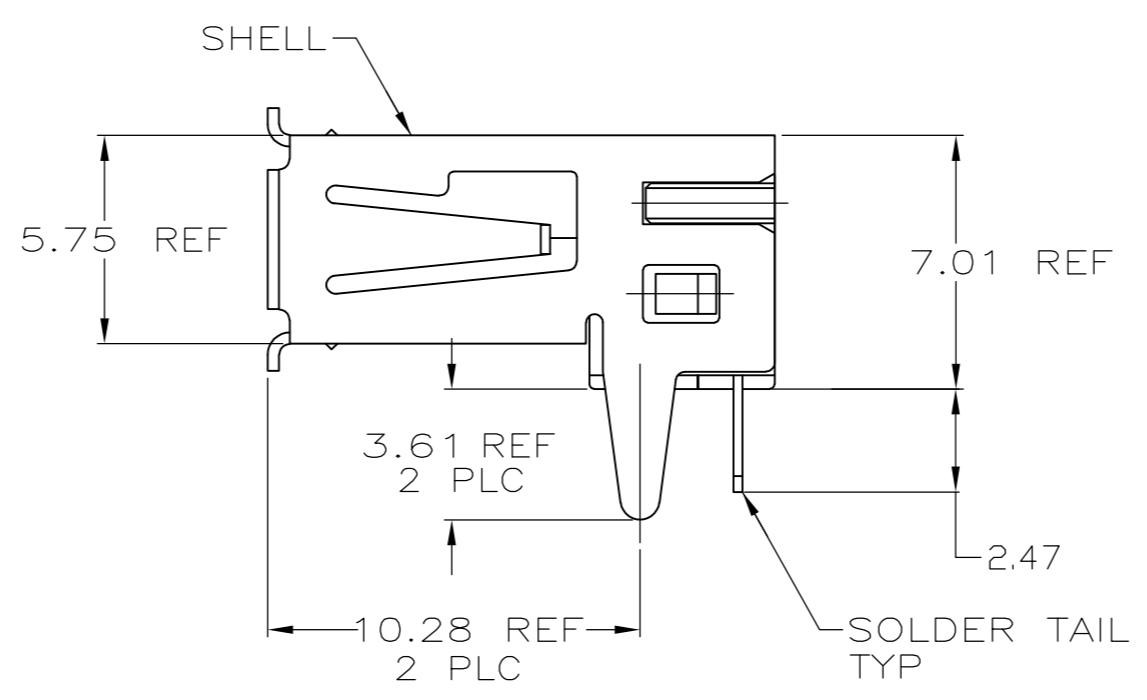
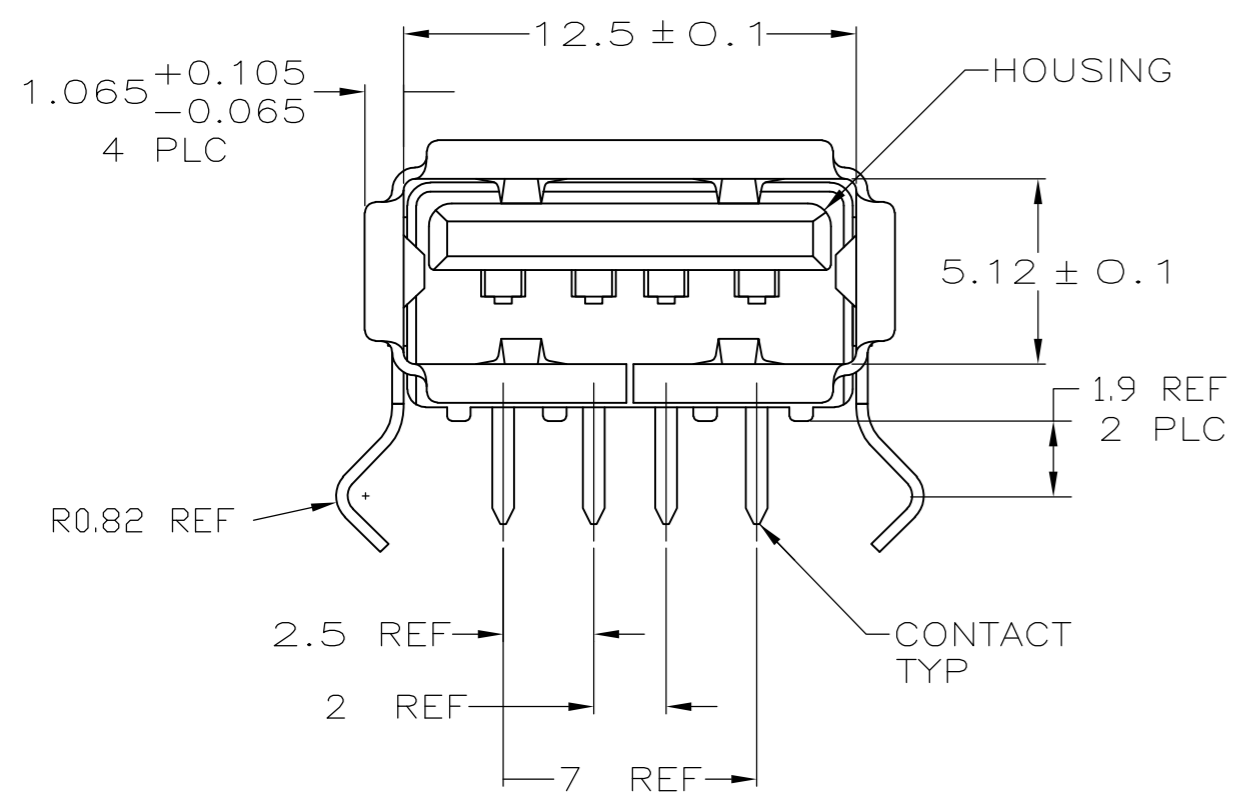

- 1 MATERIAL:
 SHELL & CONTACTS- COPPER ALLOY.
 HOUSING: UL 94V-0 RATED, THERMOPLASTIC, COLOR SEE TABLE.
- 2 PLATING:
 CONTACTS: 0.076 μm MINIMUM GOLD OVER 0.76 μm MINIMUM PALLADIUM-NICKEL ON MATING AREA.
 3.8 μm MINIMUM MATTE TIN ON SOLDER TAILS.
 BOTH OVER 1.27 μm MINIMUM NICKEL.
 CONTACT ALTERNATE PLATING: 0.76 μm MIN GOLD ON MATING AREA, 3.80 μm MIN MATTE TIN ON SOLDER TAILS, BOTH OVER 1.27 μm MIN NICKEL.
 SHELL: 2~5 μm MINIMUM BRIGHT TIN
- 3 DATUM AND BASIC DIMENSIONS ESTABLISHED BY CUSTOMER.
- 4 RECOMMENDED PC BOARD THICKNESS OF 1.2.

| | | |
|-----------------------------|---------------|-------------|
| NO | NATURAL | 292303-8 |
| HIGH TEMPERATURE COMPATIBLE | HOUSING COLOR | PART NUMBER |

| | | | | |
|--|--|-----------------------------|-----------------|---|
| THIS DRAWING IS A CONTROLLED DOCUMENT. | | DWN J.JIANG 19FEB04 | TE Connectivity | |
| DIMENSIONS: mm | | CHK S.YAO 19FEB04 | | |
| TOLERANCES UNLESS OTHERWISE SPECIFIED: | | APVD T.SASAKI 19FEB04 | NAME | |
| 0 PLC ± - 1 PLC ± - 2 PLC ± 0.25 3 PLC ± - 4 PLC ± - ANGLES ± - | | PRODUCT SPEC | | RECEPTACLE ASSEMBLY RIGHT ANGLE, 4 POSITION, T/H & SMT USB, LEAD FREE VERSION |
| MATERIAL | | APPLICATION SPEC | | |
| 1 | | WEIGHT | SIZE A2 | CAGE CODE 00779 |
| 2 | | DRAWING NO C-292303 | | |
| 3 | | CUSTOMER DRAWING | | RESTRICTED TO |
| 4 | | SCALE 5:1 SHEET 3 of 4 | | REV E7 |

292303

A

4

3

2

1

THIS DRAWING IS UNPUBLISHED. RELEASED FOR PUBLICATION. ALL RIGHTS RESERVED.

| LOC | DIST | REVISIONS | | | |
|-----|------|-------------|------|-----|------|
| P | LTR | DESCRIPTION | DATE | DWN | APVD |
| ES | 00 | SEE SHEET 1 | - | - | - |

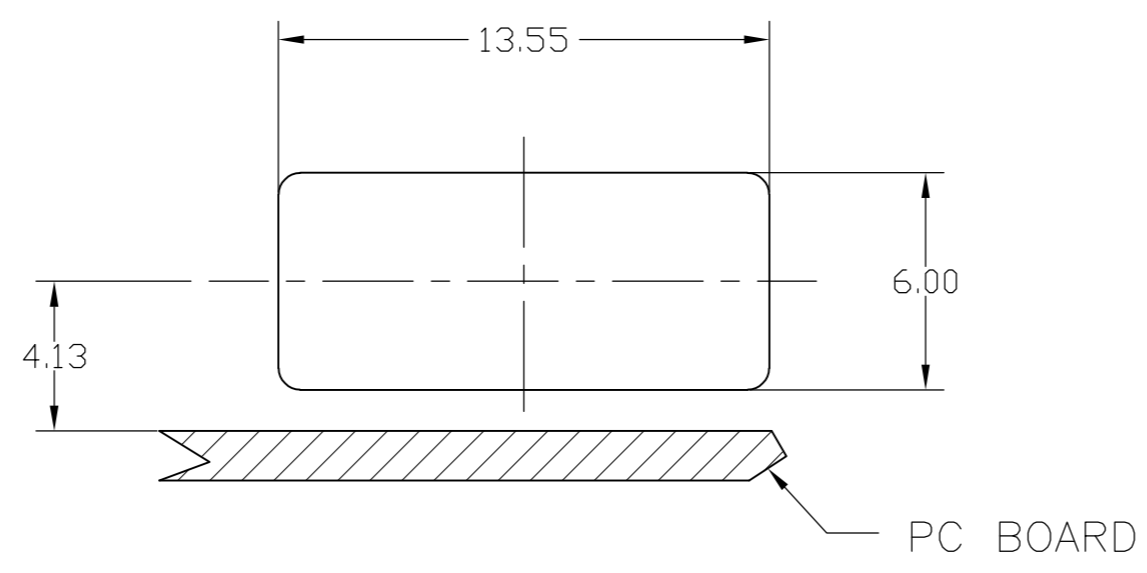
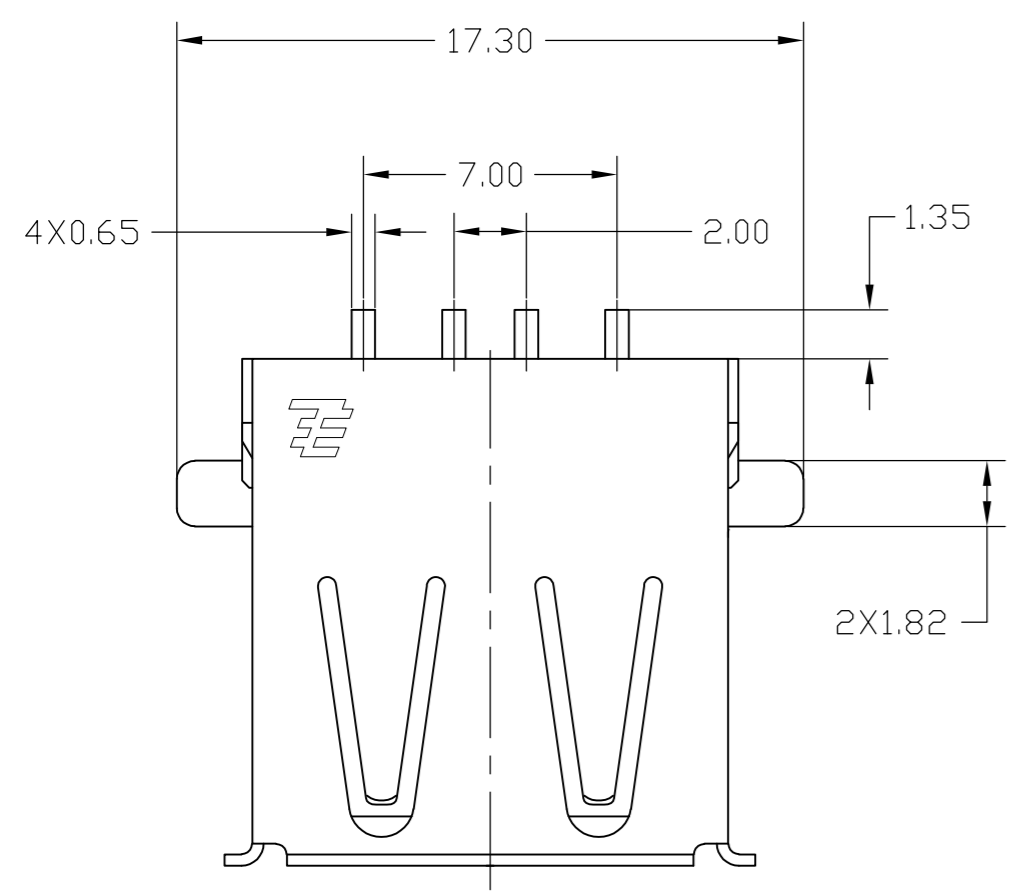

RECOMMENDED MOUNTING PANEL CUTOUT

- ⚠ MATERIAL:
SHELL & CONTACTS- COPPER ALLOY.
HOUSING: UL 94V-0 RATED, THERMOPLASTIC, COLOR SEE TABLE.
- ⚠ PLATING:
CONTACTS: 0.076 μm MINIMUM GOLD OVER 0.76 μm MINIMUM PALLADIUM-NICKEL ON MATING AREA.
3.8 μm MINIMUM MATTE TIN ON SOLDER TAILS.
BOTH OVER 1.27 μm MINIMUM NICKEL.
CONTACT ALTERNATE PLATING: 0.76 μm MIN GOLD ON MATING AREA, 3.80 μm MIN MATTE TIN ON SOLDER TAILS, BOTH OVER 1.27 μm MIN NICKEL.
SHELL: 2~5 μm MINIMUM BRIGHT TIN
- ⚠ PANEL IS NEEDED FOR CUSTOMER.
- ⚠ THIS P/N IS PRELIMINARY.

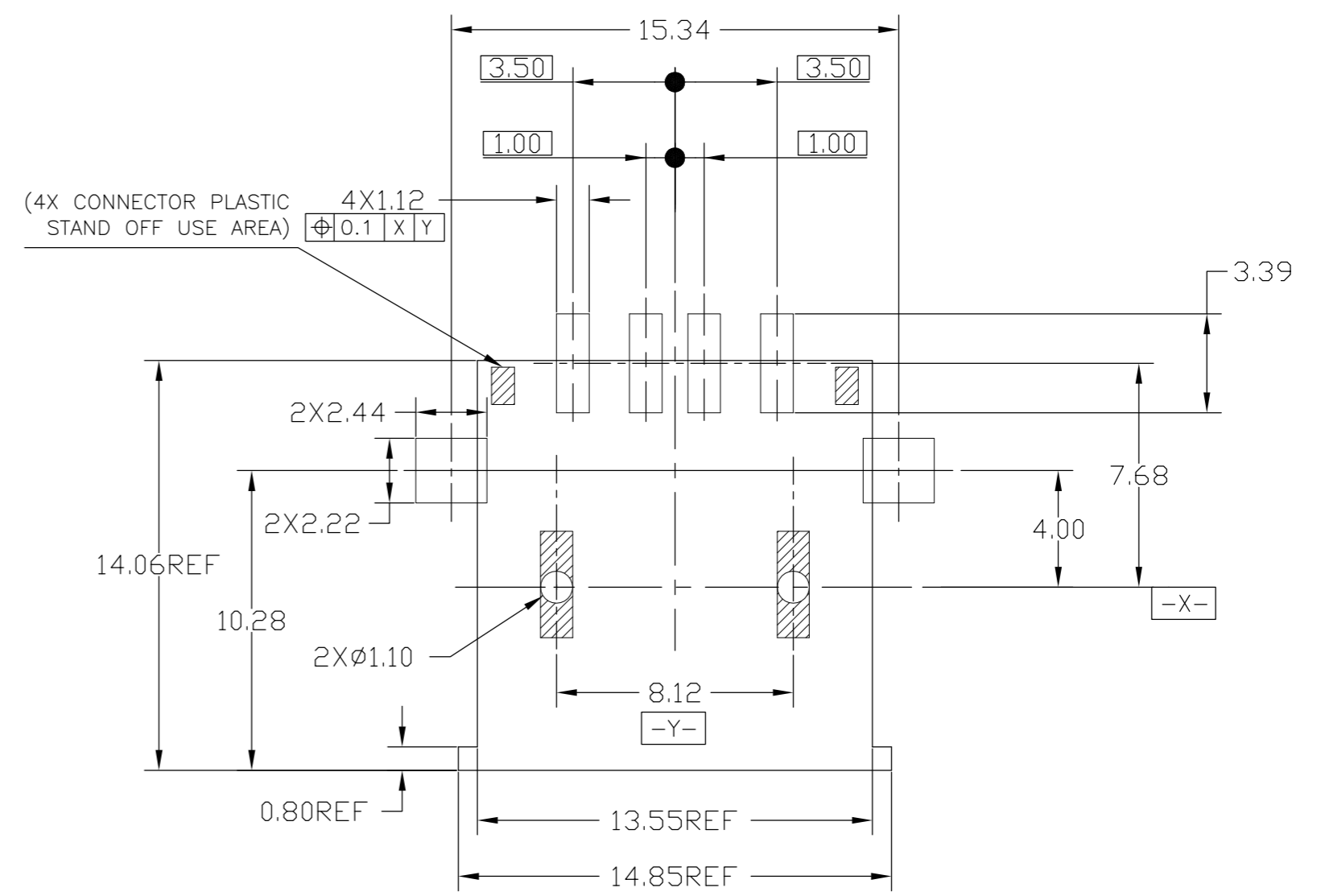
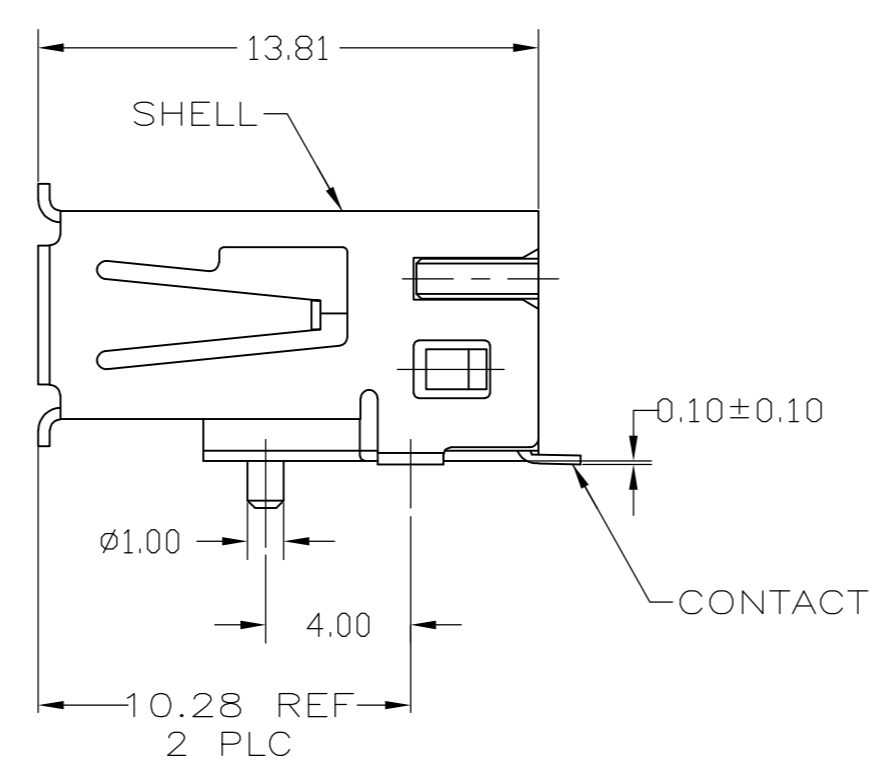
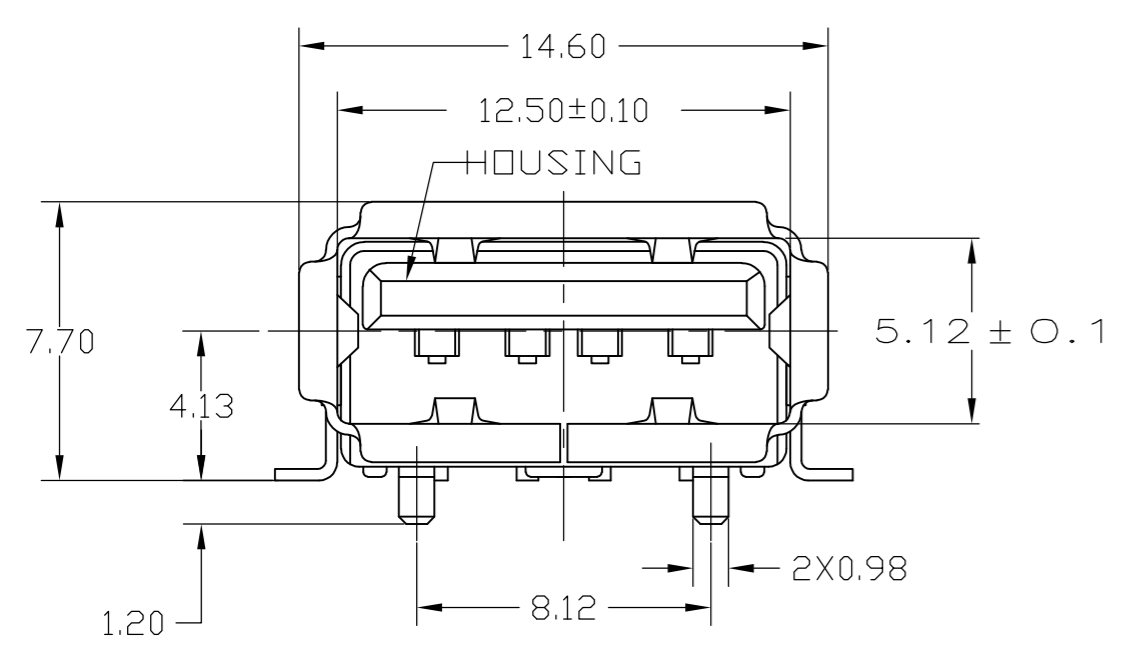

RECOMMENDED PC BOARD MOUNTING LAYOUT (TOLERANCE=±0.05)

| | | |
|-----------------------------|---------------|--------------|
| YES | BLACK | 1-292303-6 ⚠ |
| YES | NATURAL | 292303-9 |
| HIGH TEMPERATURE COMPATIBLE | HOUSING COLOR | PART NUMBER |

| | | | | | |
|--|--|-----------------------------|---|--------------------|------------------------|
| THIS DRAWING IS A CONTROLLED DOCUMENT. | | DWN J.JIANG 19FEB04 | TE Connectivity | | |
| DIMENSIONS: mm | | CHK S.YAO 19FEB04 | | | |
| TOLERANCES UNLESS OTHERWISE SPECIFIED: | | APVD T.SASAKI 19FEB04 | NAME RECEPTACLE ASSEMBLY RIGHT ANGLE, 4 POSITION, T/H & SMT USB, LEAD FREE VERSION | | |
| 0 PLC ± - 1 PLC ± - 2 PLC ± 0.25 3 PLC ± - 4 PLC ± - ANGLES ± - | | PRODUCT SPEC 108-60034 | SIZE A2 | CAGE CODE 00779 | DRAWING NO C-292303 |
| MATERIAL ⚠ | | FINISH ⚠ | WEIGHT - | RESTRICTED TO - | SCALE 5:1 |
| CUSTOMER DRAWING | | | SHEET 4 of 4 | REV E7 | |

292303