

GENERAL TECHNICAL CHARACTERISTICS

Dielectric : Polypropylene film
 Construction : Extended double side metallized carrier film
 with internal series connection and metallized film
 Case : Polyester tape wrapping; UL94V-0 resin end fill
 Leads: Tinned copper wire



ELECTRICAL CHARACTERISTICS

Working temperature : - 40 to + 85 °C
 Capacitance : 0.0068 to 6.8µF
 Rated Voltage : 700 to 3000 Vdc
 Tolerance : ± 5%, ± 10%
 Dissipation factor: Measured at 1000±20 Hz and 25±5°C.
 When $Cr \leq 1.5\mu F$, 4×10^{-4} ;
 When $Cr > 1.0\mu F$, 6×10^{-4}

TEST METHODS AND PERFORMANCES

Dielectric strength: 2Ur (DC) applied for 10s at 25±5°C (1 minute for type test)
 Insulation resistance : 3000s but need not exceed 30GΩ (typical value), after 1 minute of electrification at 100Vdc (25±5°C)

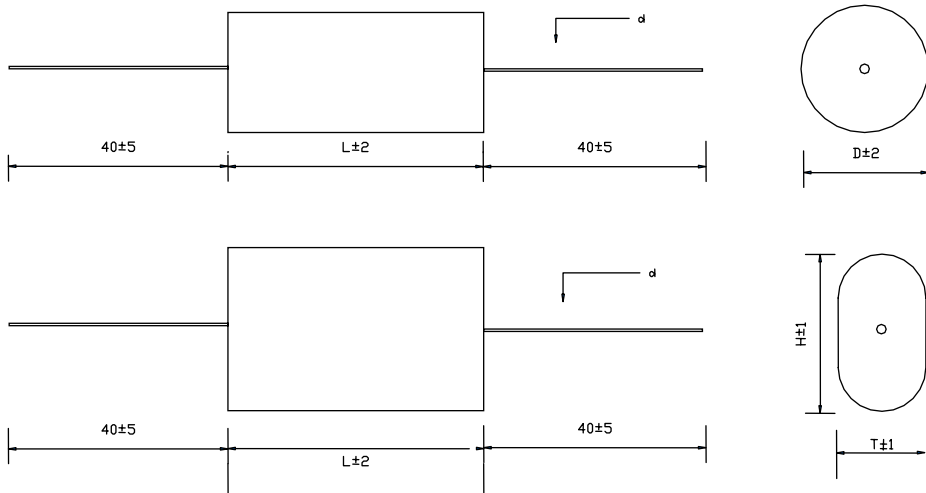

How to Order:



Electrical specifications, ordering codes

Part Nubmer	Cap (µF)	Dimension (mm)					Du/dt (v/µs)	Ipeak (A)	Irms max. (A)	ESR (mΩ)
		flat,oval								
		L	D	T	H	d				
Ur 700Vdc, Urms 380Vac, Upk 1000Vdc										
STD-700-0.22	0.22	32	11.6	8.6	13.4	0.8	480	106	5.5	6.5
STD-700-0.33	0.33	32	13.9	9.5	17.5	0.8	480	158	6	6.0
STD-700-0.47	0.47	32	16.4	11.9	19.9	0.8	480	226	8	4.7
STD-700-0.68	0.68	32	19.5	14.9	22.9	1.0	480	326	9	3.9
STD-700-0.68	0.68	44	15.7	11.2	19.2	1.0	325	221	9	4.4
STD-700-1.0	1.0	44	18.8	14.2	22.2	1.2	325	325	9	3.9
STD-700-1.5	1.5	44	22.8	18.1	26.1	1.2	325	488	12	3.3
STD-700-2.0	2.0	44	26.3	21.5	29.5	1.2	325	650	12	3.0
STD-700-2.2	2.2	44	27.5	22.7	30.7	1.2	325	715	12	2.9
STD-700-2.2	2.2	57	22.4	17.8	25.8	1.2	240	528	12	3.8
STD-700-2.5	2.5	44	29.3	24.4	32.4	1.2	325	813	12	3.5
STD-700-2.5	2.5	57	23.8	19.2	27.2	1.2	240	600	12	3.8
STD-700-3.0	3.0	44	32.0	27.1	35.1	1.2	325	975	12	3.1
STD-700-3.0	3.0	57	26.2	21.3	29.3	1.2	240	720	12	3.3
STD-700-3.3	3.3	44	33.5	28.6	36.6	1.2	325	1073	12	2.9
STD-700-3.5	3.5	57	28.2	23.3	31.3	1.2	240	840	12	2.7
STD-700-4.0	4.0	57	30.0	25.2	33.2	1.2	240	960	12	2.6
STD-700-4.7	4.7	57	32.5	27.6	35.6	1.2	240	1128	12	2.5
STD-700-5.6	5.6	57	35.4	30.5	38.5	1.2	240	1344	12	2.3
STD-700-6.8	6.8	57	38.9	34.0	42.0	1.2	240	1632	12	2.0
Ur 850Vdc, Urms 450Vac, Upk 1200Vdc										
STD-850-0.10	0.10	32	9.5	6.5	11.3	0.8	700	70	4	11.5
STD-850-0.15	0.15	32	11.3	8.3	13.1	0.8	700	105	5.5	8.6
STD-850-0.22	0.22	32	13.5	9.1	17.1	0.8	700	154	6.5	6.5
STD-850-0.22	0.22	44	10.9	7.9	12.7	0.8	400	88	6.5	7.9
STD-850-0.33	0.33	32	16.2	11.7	19.7	1.0	700	231	8	4.8
STD-850-0.33	0.33	44	13.1	8.7	16.7	1.0	400	132	7.5	6.1
STD-850-0.47	0.47	32	19.2	14.6	22.6	1.0	700	329	9	4.0
STD-850-0.47	0.47	44	15.4	10.9	18.9	1.0	400	188	9	5.0
STD-850-0.68	0.68	44	18.3	13.8	21.8	1.0	400	272	9	3.2
STD-850-1.0	1.0	44	22.0	17.4	25.4	1.2	400	400	12	3.3
STD-850-1.5	1.5	44	26.9	22.1	30.1	1.2	400	600	12	2.8
STD-850-2.0	2.0	44	30.9	26.1	34.1	1.2	400	800	12	3.0
STD-850-2.2	2.2	44	32.4	27.5	35.5	1.2	400	880	12	2.3
STD-850-2.2	2.2	57	26.5	21.6	29.6	1.2	290	638	12	2.8
STD-850-2.5	2.5	44	34.4	29.6	37.6	1.2	400	1000	12	2.6
STD-850-2.5	2.5	57	28.1	23.3	31.3	1.2	290	725	12	2.8
STD-850-3.0	3.0	57	30.7	25.9	33.9	1.2	290	870	12	2.6
STD-850-3.3	3.3	57	32.2	27.3	35.3	1.2	290	957	12	2.4
STD-850-4.0	4.0	57	35.3	30.5	38.5	1.2	290	1160	12	2.3
STD-850-4.7	4.7	57	38.2	33.3	41.3	1.2	290	1363	12	2.0
Ur 1000Vdc, Urms 480Vac, Upk 1400Vdc										
STD-1000-0.10	0.10	32	10.7	7.7	12.5	0.8	850	85	5	8.5
STD-1000-0.15	0.15	32	12.9	8.5	16.5	0.8	850	128	6	8.2
STD-1000-0.22	0.22	32	15.3	10.9	18.9	1.0	850	187	7	5.9
STD-1000-0.33	0.33	32	18.5	14.0	22.0	1.0	850	281	9	4.5
STD-1000-0.33	0.33	44	14.9	10.5	18.5	1.0	570	188	9	5.8
STD-1000-0.47	0.47	32	21.9	17.3	25.3	1.0	850	400	9	3.8
STD-1000-0.47	0.47	44	17.6	13.1	21.1	1.0	570	268	9	4.7
STD-1000-0.68	0.68	44	21.0	16.4	24.4	1.0	570	388	9	4.0
STD-1000-1.0	1.0	44	25.4	20.6	28.6	1.2	570	570	12	3.2
STD-1000-1.5	1.5	44	30.9	26.0	34.0	1.2	570	855	12	3.6
STD-1000-1.5	1.5	57	25.1	20.4	28.4	1.2	340	510	12	3.9
STD-1000-2.0	2.0	57	29.0	24.1	32.1	1.2	340	680	12	3.0

Electrical specifications, ordering codes

Part Number	Cap (µF)	Dimension (mm)					Du/dt (V/µs)	Ipeak (A)	Irms max. (A)	ESR (mΩ)
		flat, oval								
		L	D	T	H	d				
STD-1000-2.2	2.2	57	30.3	25.5	33.5	1.2	340	748	12	2.7
STD-1000-3.0	3.0	57	35.3	30.4	38.4	1.2	340	1020	12	2.4
STD-1000-3.3	3.3	57	36.9	32.1	40.1	1.2	340	1122	12	2.1
Ur 1200Vdc, Urms 500Vac, Upk 1600Vdc										
STD-1200-0.047	0.047	32	8.5	5.5	10.3	0.8	1100	52	3	19.4
STD-1200-0.068	0.068	32	9.9	6.9	11.7	0.8	1100	75	3.5	12.0
STD-1200-0.10	0.10	32	11.7	8.7	13.5	0.8	1100	110	5	10.7
STD-1200-0.10	0.10	44	9.4	6.4	11.2	0.8	650	65	5	13.1
STD-1200-0.15	0.15	32	14.0	9.6	17.6	1.0	1100	165	6	7.7
STD-1200-0.15	0.15	44	11.2	8.2	13.0	0.8	650	98	6	10.0
STD-1200-0.22	0.22	32	16.8	12.3	20.3	1.0	1100	242	9	5.4
STD-1200-0.22	0.22	44	13.3	8.9	16.9	1.0	650	143	9	7.6
STD-1200-0.33	0.33	32	20.3	14.3	25.5	1.0	1100	363	9	4.5
STD-1200-0.33	0.33	44	16.1	11.6	19.6	1.0	650	215	9	5.4
STD-1200-0.47	0.47	44	19.0	14.4	22.4	1.0	650	306	9	4.8
STD-1200-0.68	0.68	44	22.6	18.0	26.0	1.2	650	442	12	3.9
STD-1200-1.0	1.0	44	27.4	22.5	30.5	1.2	650	650	12	3.4
STD-1200-1.0	1.0	57	22.7	18.0	26.0	1.2	385	385	12	3.8
STD-1200-1.2	1.2	44	29.9	25.0	33.0	1.2	650	780	12	3.0
STD-1200-1.2	1.2	57	24.9	20.1	28.1	1.2	385	462	12	3.4
STD-1200-1.5	1.5	44	33.3	28.4	36.4	1.2	650	975	12	2.7
STD-1200-1.5	1.5	57	27.7	22.9	30.9	1.2	385	578	12	3.0
STD-1200-2.0	2.0	57	31.8	26.9	34.9	1.2	385	770	12	2.6
STD-1200-2.2	2.2	57	33.3	28.4	36.4	1.2	385	847	12	2.5
STD-1200-2.5	2.5	57	35.4	30.6	38.6	1.2	385	963	12	2.3
STD-1200-3.0	3.0	57	38.7	33.9	41.9	1.2	385	1155	12	2.0
Ur 1500Vdc, Urms 575Vac, Upk 2000Vdc										
STD-1500-0.068	0.068	32	12.2	9.2	14.0	0.8	1225	83	4	13.8
STD-1500-0.10	0.10	32	14.5	10.0	18.0	0.8	1225	123	5.5	9.6
STD-1500-0.15	0.15	32	17.5	13.0	21.0	1.0	1225	184	7	7.2
STD-1500-0.22	0.22	32	21.0	16.4	24.4	1.0	1225	270	9	5.3
STD-1500-0.22	0.22	44	16.8	12.3	20.3	1.0	800	176	9	7.0
STD-1500-0.33	0.33	44	20.4	15.8	23.8	1.0	800	264	9	5.3
STD-1500-0.47	0.47	44	24.2	19.5	27.5	1.2	800	376	11	4.3
STD-1500-0.68	0.68	44	29.0	24.2	32.2	1.2	800	544	12	3.7
STD-1500-1.0	1.0	44	35.0	30.1	38.1	1.2	800	800	12	3.2
STD-1500-1.0	1.0	57	28.6	23.8	31.8	1.2	570	570	12	3.7
STD-1500-1.2	1.2	57	31.2	26.4	34.4	1.2	570	684	12	3.4
STD-1500-1.5	1.5	57	34.8	29.9	37.9	1.2	570	855	12	2.9
STD-1500-2.0	2.0	57	40.0	35.1	43.1	1.2	570	1140	12	2.5
Ur 2000Vdc, Urms 630Vac, Upk 2400Vdc										
STD-2000-0.022	0.022	32	9.0	6.0	10.8	0.8	1750	39	2.5	34.5
STD-2000-0.033	0.033	32	10.6	7.6	12.4	0.8	1750	58	3.5	23.7
STD-2000-0.047	0.047	32	12.4	9.4	14.2	0.8	1750	82	4.5	16.8
STD-2000-0.047	0.047	44	10.2	7.2	12.0	0.8	1000	47	4	21.0
STD-2000-0.068	0.068	32	14.7	10.3	18.3	1.0	1750	119	5.5	11.8
STD-2000-0.068	0.068	44	11.9	8.9	13.7	0.8	1000	68	5.5	16.3
STD-2000-0.10	0.10	32	17.6	13.1	21.1	1.0	1750	175	7.5	8.4
STD-2000-0.10	0.10	44	14.2	9.8	17.8	1.0	1000	100	7	12.4
STD-2000-0.15	0.15	44	17.2	12.6	20.6	1.0	1000	150	9	6.6
STD-2000-0.22	0.22	44	20.6	16.0	24.0	1.0	1000	220	9	6.0
STD-2000-0.33	0.33	44	25.0	20.3	28.3	1.2	1000	330	12	4.7
STD-2000-0.47	0.47	44	29.9	25.0	33.0	1.2	1000	473	12	3.9
STD-2000-0.56	0.56	44	32.4	27.6	35.6	1.2	1000	560	12	3.6
STD-2000-0.56	0.56	57	26.5	21.7	29.7	1.2	640	358	12	4.5

Electrical specifications, ordering codes

Part Number	Cap (µF)	Dimension (mm)					Du/dt (v/µs)	Ipeak (A)	Irms max. (A)	ESR (mΩ)
		flat, oval								
		L	D	T	H	d				
STD-2000-0.68	0.68	57	29.1	24.3	32.3	1.2	640	435	12	4.0
STD-2000-1.0	1.0	57	35.1	30.2	38.2	1.2	640	640	12	3.3
STD-2000-1.2	1.2	57	38.3	33.5	41.5	1.2	640	768	12	3.0
Ur 2500Vdc, Urms 700Vac, Upk 3000Vdc										
STD-2500-0.022	0.022	32	10.7	7.7	12.5	0.8	2150	47	3.5	24.0
STD-2500-0.033	0.033	32	12.8	8.4	16.4	0.8	2150	71	4	22.7
STD-2500-0.047	0.047	32	15.0	10.5	18.5	0.8	2150	101	5	15.5
STD-2500-0.068	0.068	32	17.8	13.3	21.3	1.0	2150	146	6.5	11.1
STD-2500-0.10	0.10	32	21.4	16.8	24.8	1.0	2150	215	8.5	7.8
STD-2500-0.10	0.10	44	17.2	12.7	20.7	1.0	1350	135	8.5	12.2
STD-2500-0.15	0.15	44	20.8	16.2	24.2	1.0	1350	203	9	8.1
STD-2500-0.22	0.22	44	25.0	20.4	28.4	1.2	1350	297	11	5.9
STD-2500-0.33	0.33	44	30.6	25.7	33.7	1.2	1350	446	12	4.5
STD-2500-0.33	0.33	57	24.9	20.2	28.2	1.2	880	290	12	5.4
STD-2500-0.47	0.47	57	29.7	24.8	32.8	1.2	880	414	12	4.4
STD-2500-0.68	0.68	57	35.5	30.6	38.6	1.2	880	598	12	3.7
STD-2500-0.82	0.82	57	38.9	34.0	42.0	1.2	880	722	12	3.3
Ur 3000Vdc, Urms 750Vac, Upk 3500Vdc										
STD-3000-0.0068	0.0068	32	8.2	5.2	10.0	0.8	2750	19	1.5	89.0
STD-3000-0.010	0.010	32	9.6	6.6	11.4	0.8	2750	28	2	61.0
STD-3000-0.015	0.015	32	11.4	8.4	13.2	0.8	2750	41	3	42.5
STD-3000-0.022	0.022	32	13.5	9.1	17.1	0.8	2750	61	4	28.5
STD-3000-0.033	0.033	32	16.3	11.8	19.8	1.0	2750	91	5	19.7
STD-3000-0.047	0.047	32	19.3	14.7	22.7	1.0	2750	129	6.5	13.8
STD-3000-0.047	0.047	44	15.5	11.0	19.0	1.0	1600	75	6	17.8
STD-3000-0.068	0.068	44	18.5	13.9	21.9	1.0	1600	109	8	12.8
STD-3000-0.10	0.10	44	22.2	17.6	25.6	1.2	1600	160	11	9.4
STD-3000-0.15	0.15	44	27.1	22.3	30.3	1.2	1600	240	12	6.8
STD-3000-0.22	0.22	44	32.6	27.7	35.7	1.2	1600	352	12	5.2
STD-3000-0.22	0.22	57	26.7	21.8	29.8	1.2	990	218	12	5.9
STD-3000-0.33	0.33	57	32.4	27.6	35.6	1.2	990	327	12	4.9
STD-3000-0.39	0.39	57	35.1	30.3	38.3	1.2	990	386	12	4.4
STD-3000-0.47	0.47	57	38.5	33.6	41.6	1.2	990	465	12	4.0

Different values ,Custom design available upon request
 More Snubber capacitors options, refer to STM,STS,STC,STE,STB

How to Order:

STD- 1200 – 0.47 – 44 FO

